

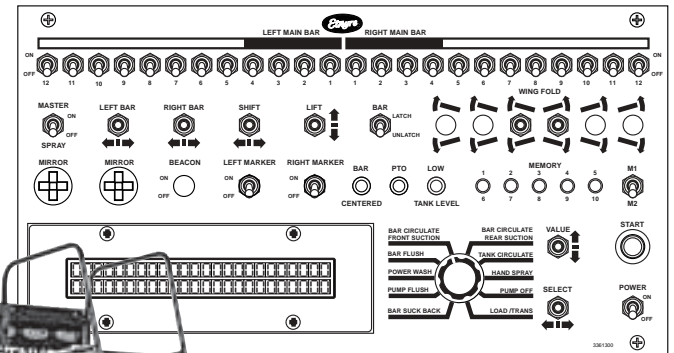

# Centennial

## Flow Charts and Control Positions Variable Width Spraybar

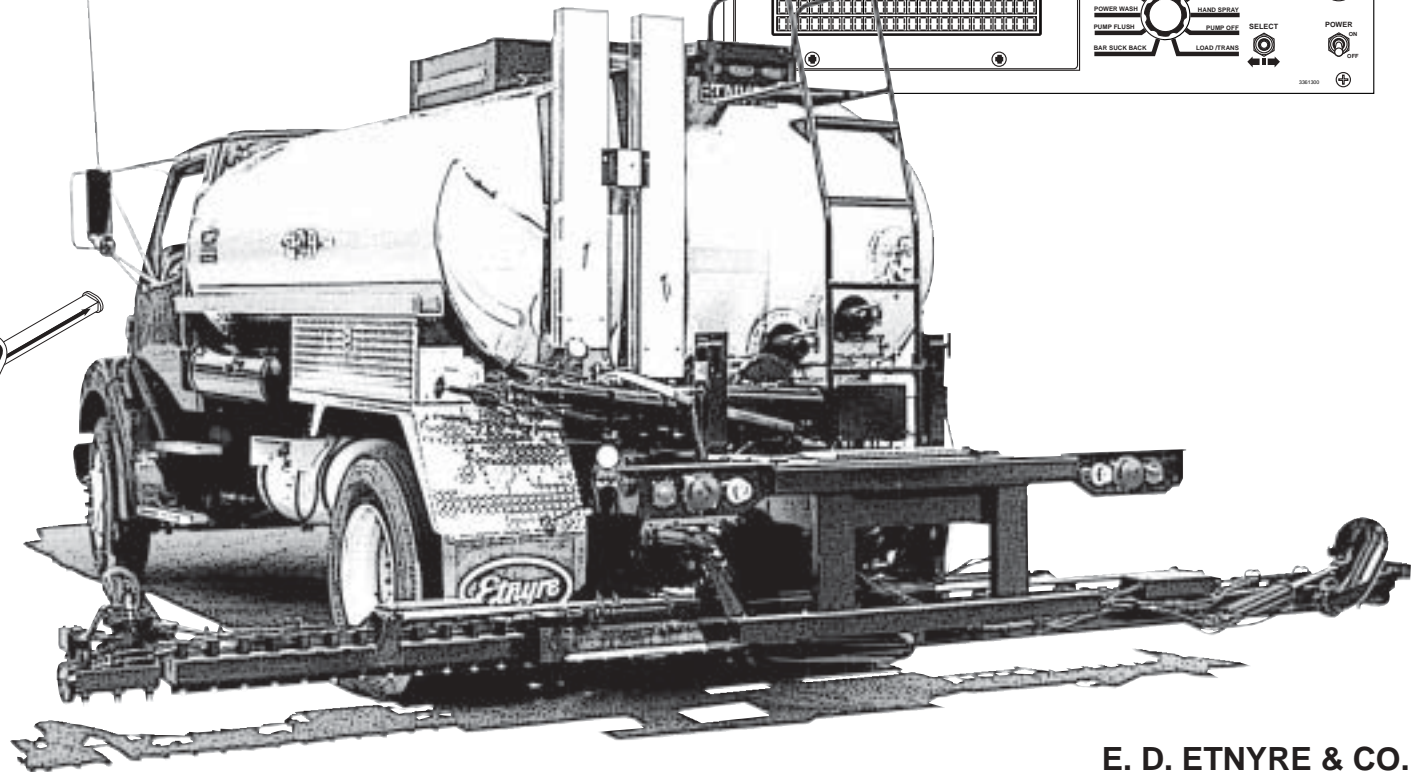
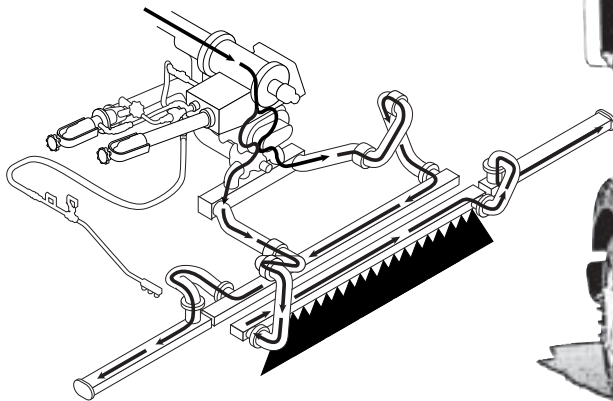

**E. D. ETNYRE & CO.**  
1333 S. Daysville Road, Oregon, Illinois 61061  
Phone: 815/732-2116 Fax: Sales 815-732-7400  
email: sales@etnyre.com www.etnyre.com

## Contents

Etnyre Spray Bar Nozzles .....	3
Fill through Fill Line .....	4
Fill through Manhole .....	5
Circulate In Tank .....	6
Circulate In Bar .....	7
Spray .....	8
Suckback Spraybar .....	9
Handspray .....	10
Handspray Suckback .....	11
Pump Off .....	12
Transfer .....	13
Flushing .....	14
Flushing Bar .....	15

## Important

The instructions represented here are a guide and not designed to be comprehensive. Refer to M-114 Centennial Asphalt Distributor Operation, Maintenance and Safety manual for complete instructions.

This pamphlet is provided as a tool to aid personnel in the operation of the Etnyre Blacktopper Centennial Distributor, as with any type of construction equipment, there are certain hazards associated with improper or careless operation. The ability to read and understand the instructions should be a required qualification to become an operator. There are also functions that require a certain amount of physical strength to accomplish. Persons lacking the required strength may not only place themselves in jeopardy, but also others in the vicinity. **Read and understand the Safety precautions found in M-114 Centennial Asphalt Distributor Operation, Maintenance and Safety manual before operating this machine.**

If you have any questions regarding this pamphlet or the operation of your unit, contact your Etnyre dealer or the E. D. Etnyre Service Department at 1-800-995-2116.



### WARNING

Do not use this machine for any operation which is not described in the Operation manual.

If you have any questions about the operation of this machine, contact the Etnyre Service Department at 1-800-995-2116 or 1-815-732-2116.

Operations that are not approved could cause serious injury or death.

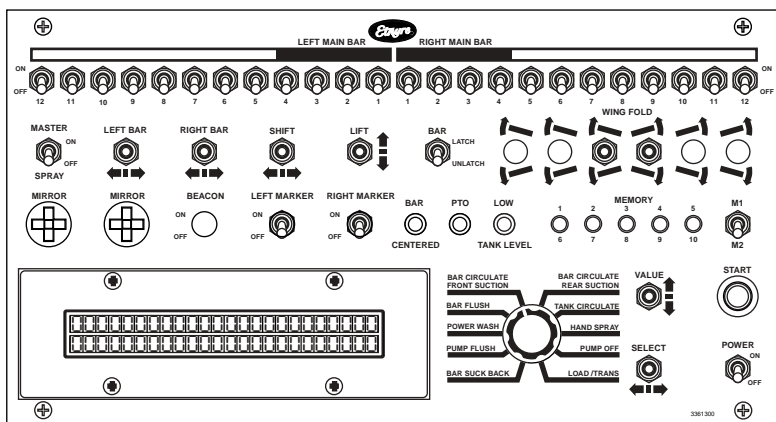

## Control Panels

### ◀ Cab Control Panel Rear Control Panel ▶

All functions can be operated from either the Front or Rear Pump Control mode. However, Handspray operation is only recommended in Front Mode.

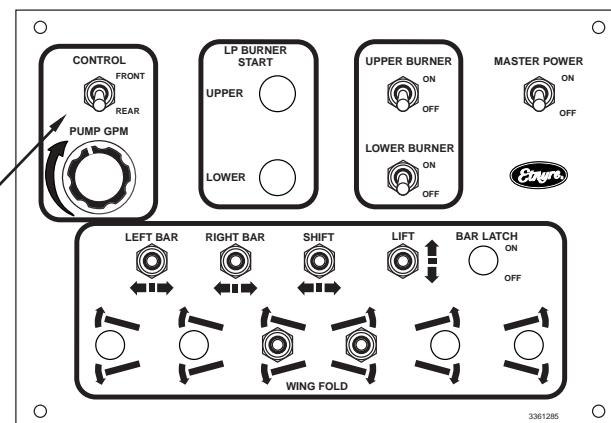

## Etnyre Spray Bar Nozzles

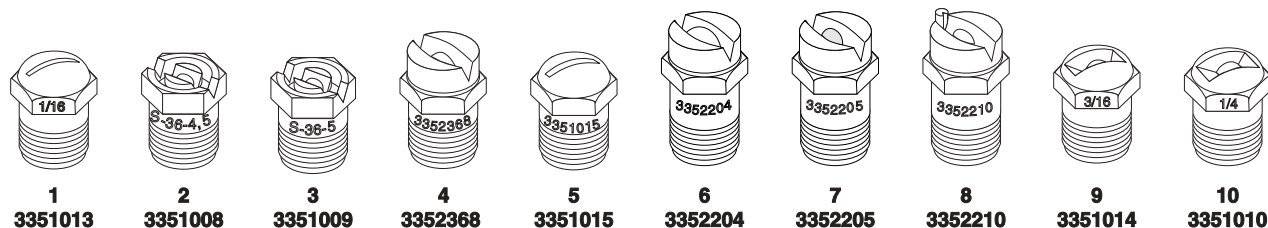

Ref.	Part No.	Description	Application Per Square Yard	Application (Metric) Liters Per Square Meter	Flow Gallons Per Minute Per Foot
1	3351013	1/16" Coin Slot	.05 - .20	.19 - .75	3.0 to 4.5
2	3351008	S36-4 V Slot	.10 - .35	.38 - 1.30	4.0 to 7.5
3	3351009	S36-5 V Slot	.18 - .45	.57 - 2.08	7.0 to 10.0
4	3352368	Multi-Material V Slot	.15 - .40	.57 - 1.50	6.0 to 9.0
5	3351015	3/32" Coin Slot	.15 - .40	.57 - 1.50	6.0 to 9.0
6	3352204	Multi-Material V Slot	.35 - .95	1.30 - 3.60	12.0 to 21.0
7	3352205	Multi-Material V Slot	.20 - .55	.75 - 2.08	7.5 to 12.0
8	3352210	End Nozzle (3352205)	.20 - .55	.75 - 2.08	7.5 to 12.0
9	3351014	3/16" Coin Slot	.35 - .95	1.30 - 3.60	12.0 to 21.0
10	3351010	1/4" Coin Slot	.40 - 1.10	1.50 - 4.16	15.0 to 24.0

# Fill through Fill Line

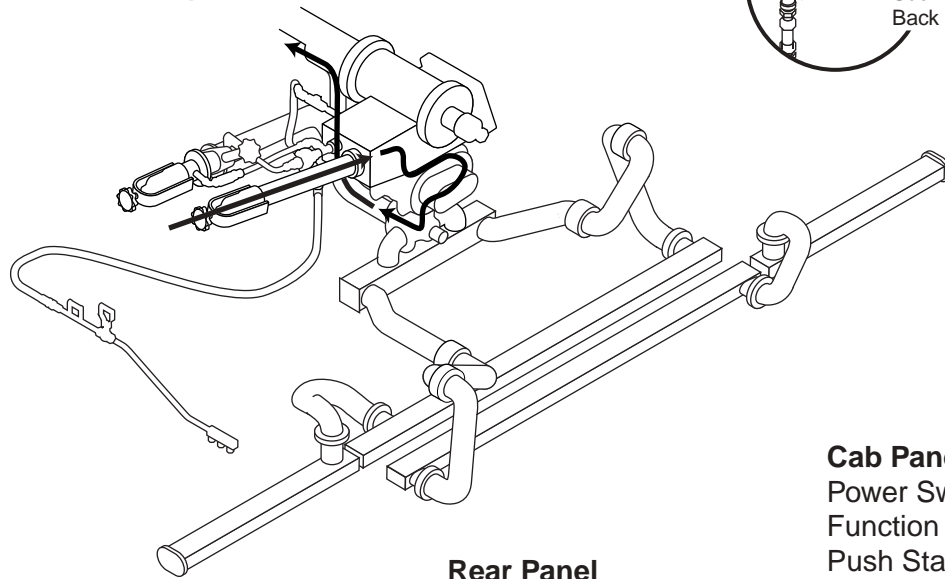

**Rear Panel**  
Master Power ON  
Pump Control FRONT

To increase pump (GPM) using rear knob, place CONTROL switch to REAR and rotate knob.

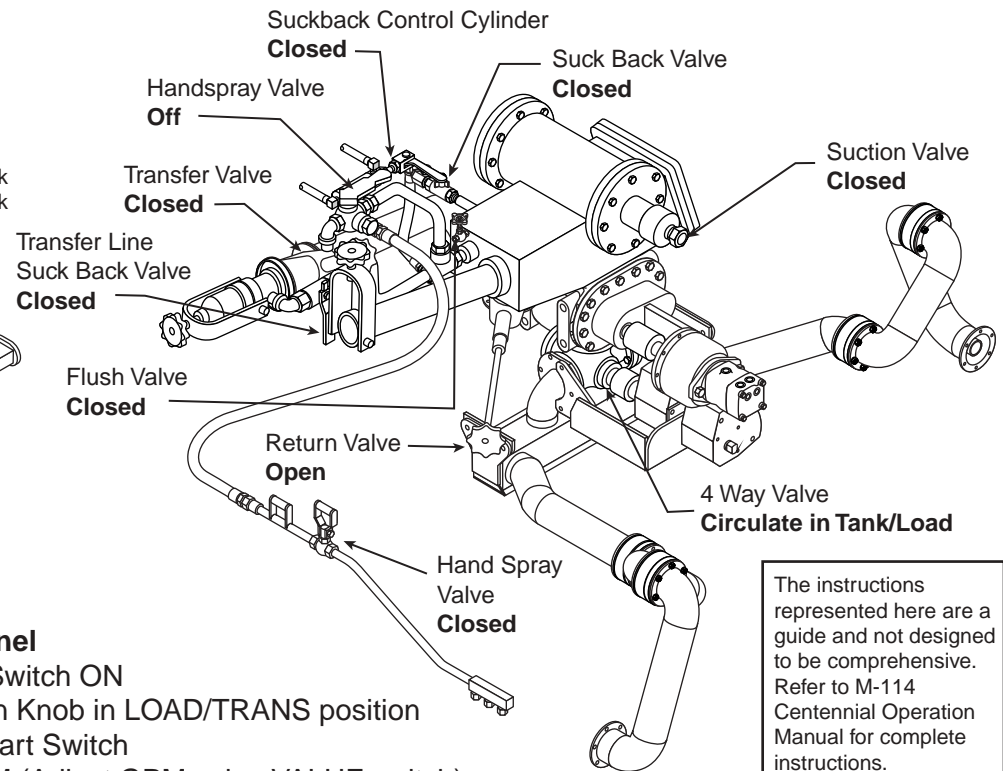
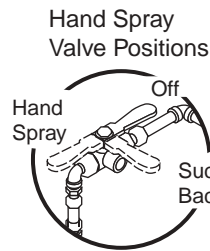
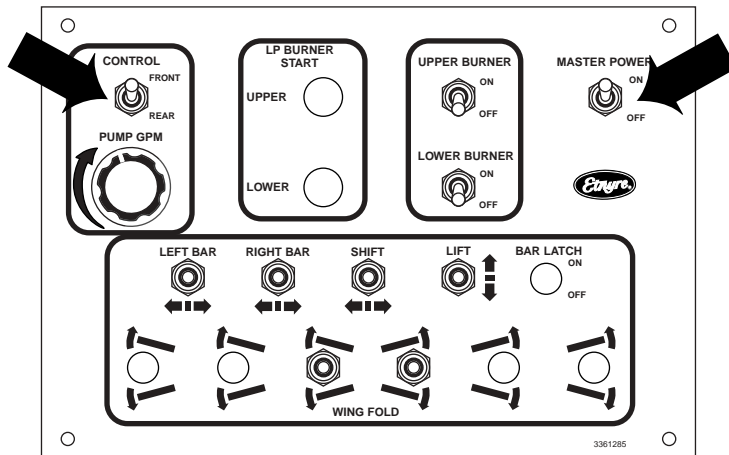

The instructions represented here are a guide and not designed to be comprehensive. Refer to M-114 Centennial Operation Manual for complete instructions.

**Cab Panel**  
Power Switch ON  
Function Knob in LOAD/TRANS position  
Push Start Switch  
100GPM (Adjust GPM using VALUE switch)

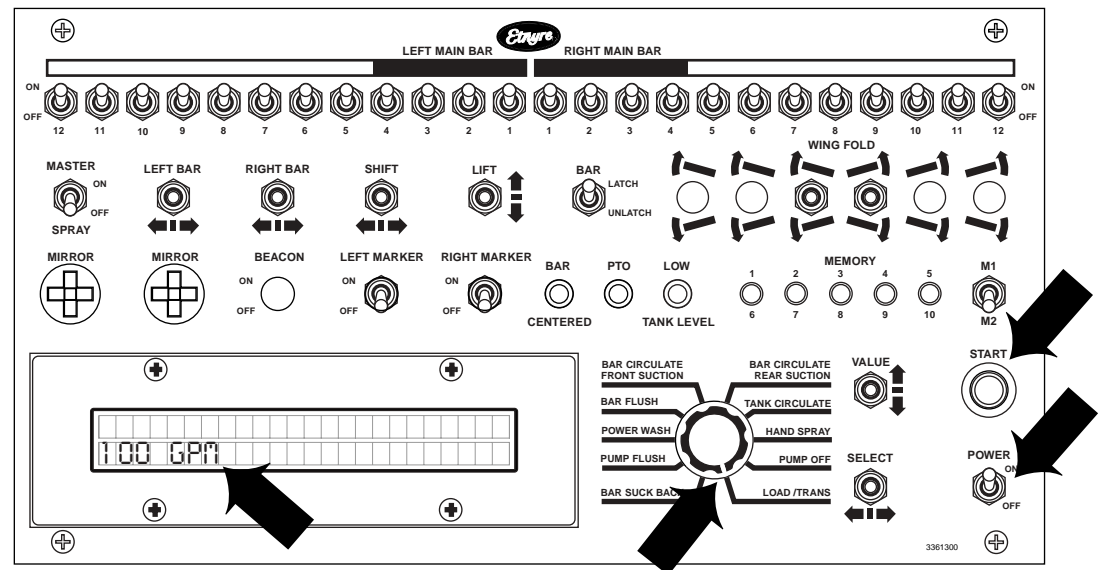

# Fill through Manhole

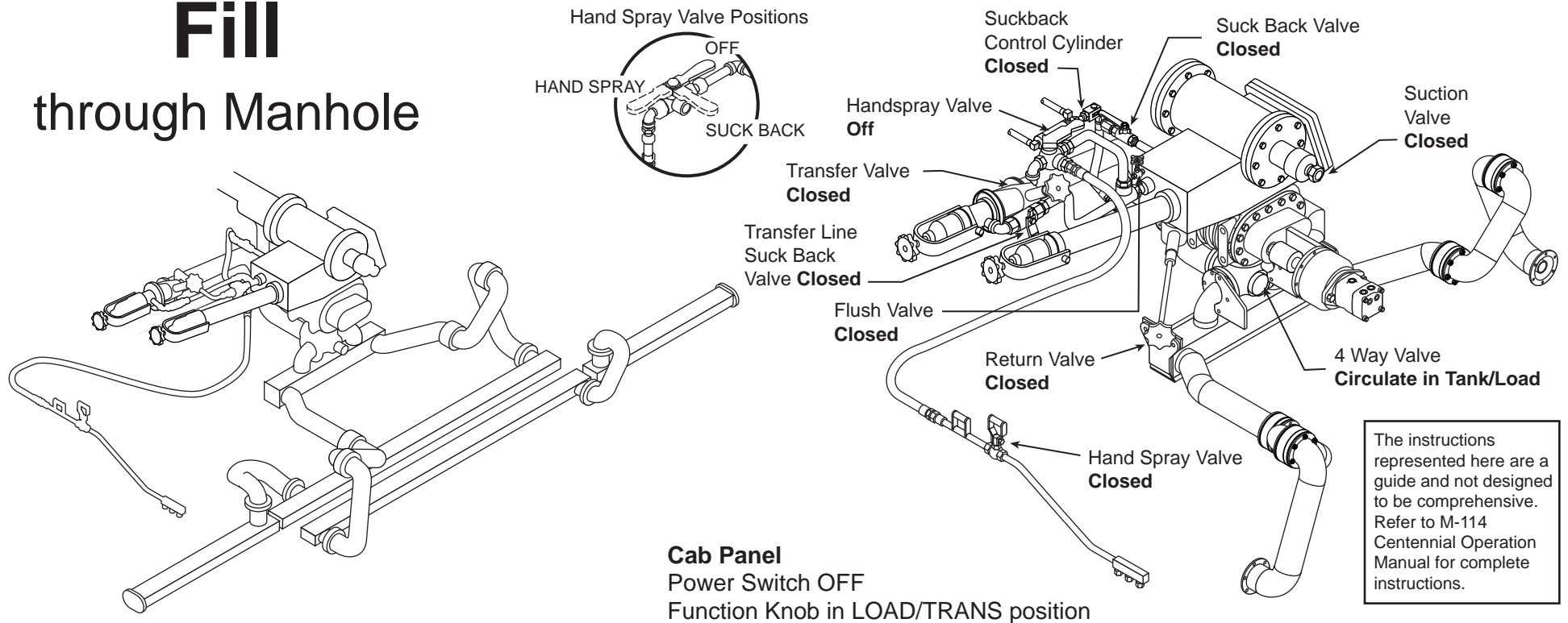

**Cab Panel**  
Power Switch OFF  
Function Knob in LOAD/TRANS position

## Rear Panel

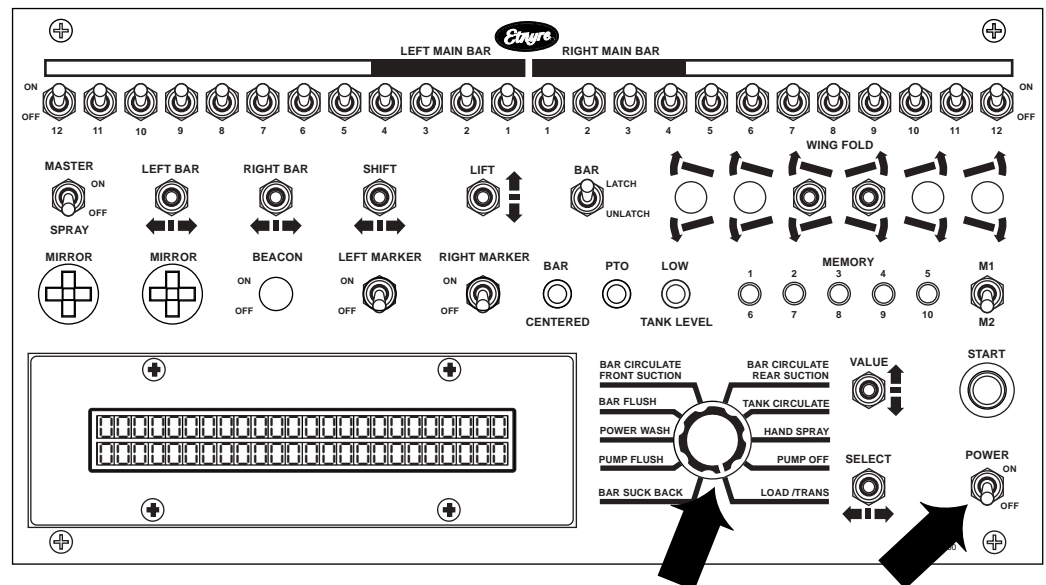
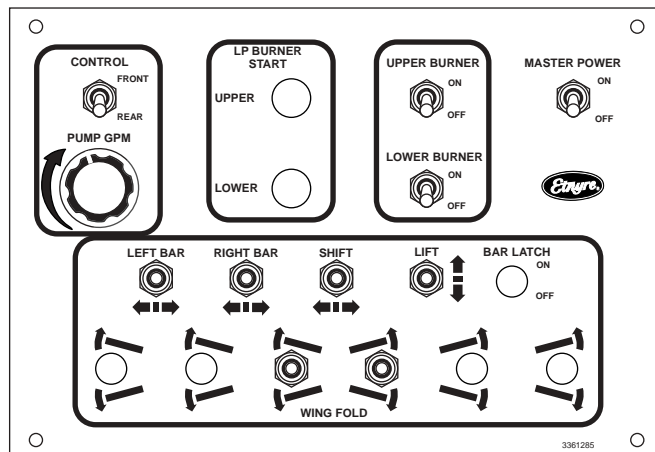



# Circulate In Tank

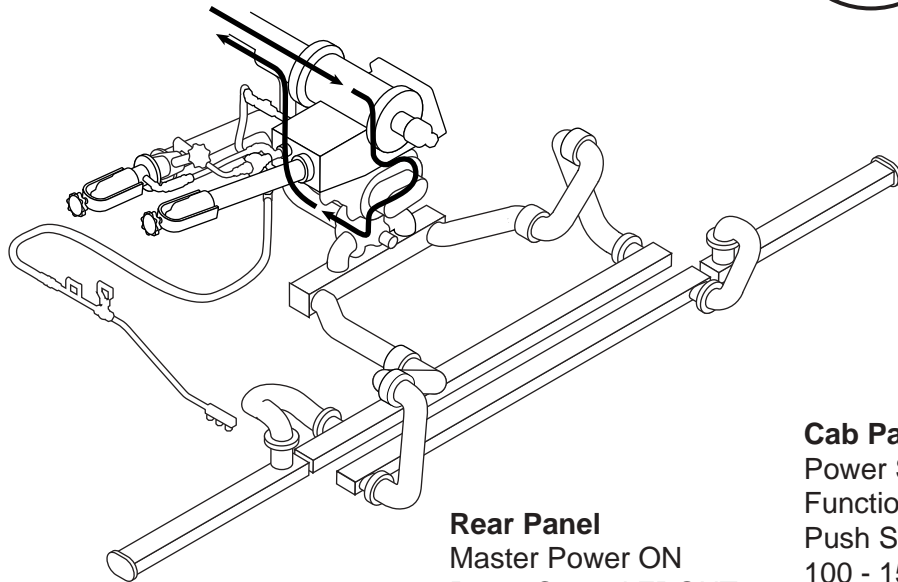

To increase pump (GPM) using rear knob, place CONTROL switch to REAR and rotate knob.

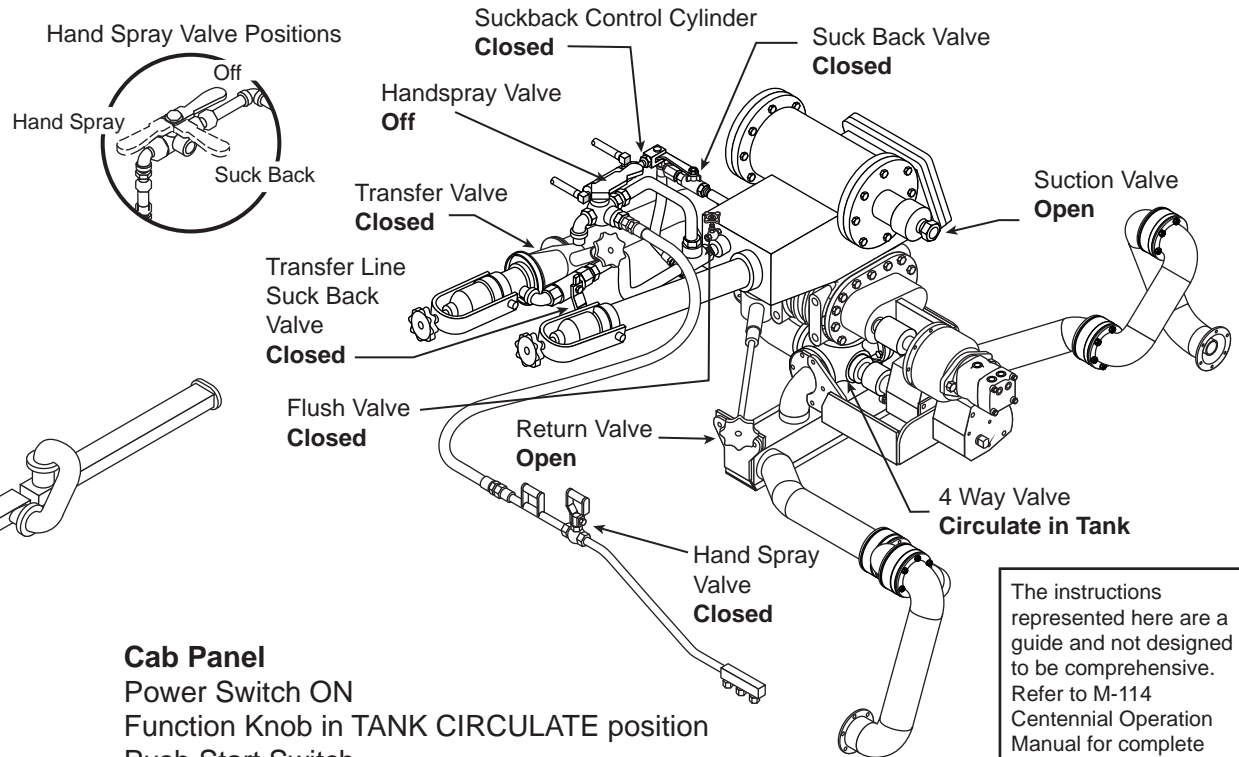
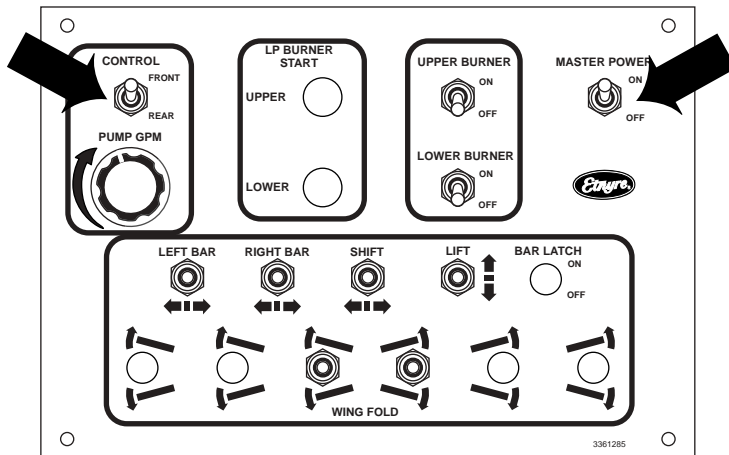

## Cab Panel

Power Switch ON

Function Knob in TANK CIRCULATE position

Push Start Switch

100 - 150 GPM (Adjust GPM using VALUE switch)

The instructions represented here are a guide and not designed to be comprehensive. Refer to M-114 Centennial Operation Manual for complete instructions.

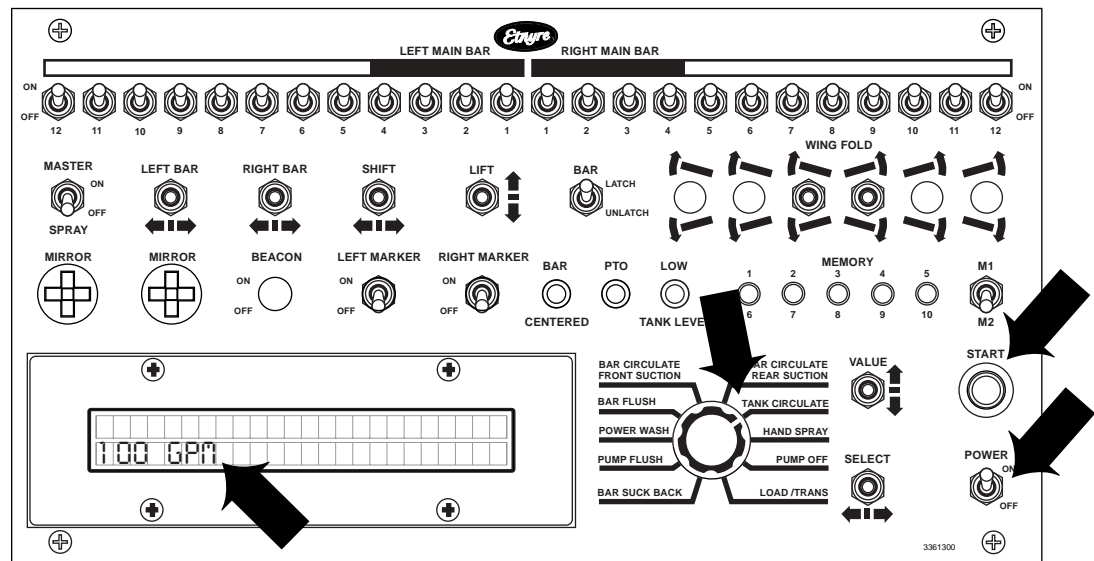

# Circulate In Bar

Hand Spray Valve Positions

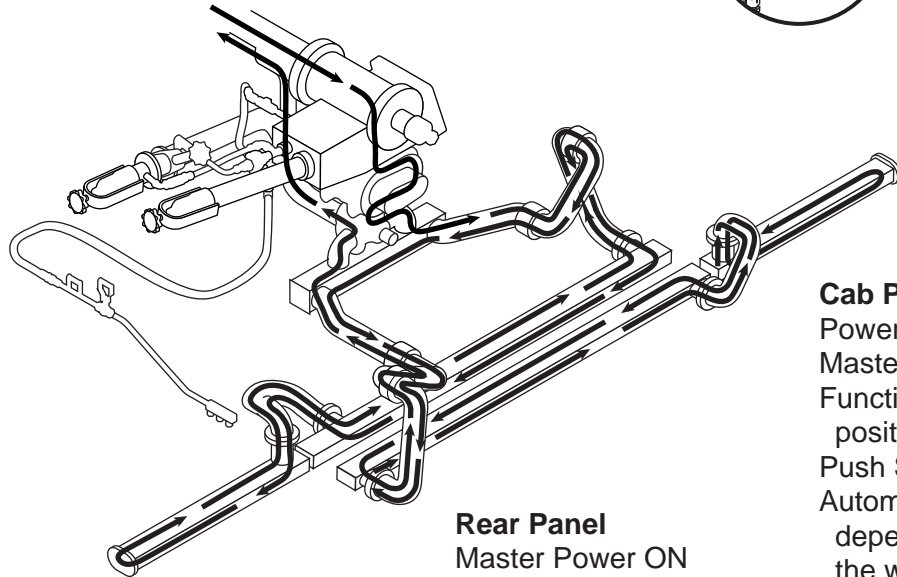
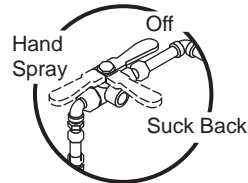

**Rear Panel**  
Master Power ON  
Pump Control FRONT

To increase pump (GPM) using rear knob, place CONTROL switch to REAR and rotate knob.

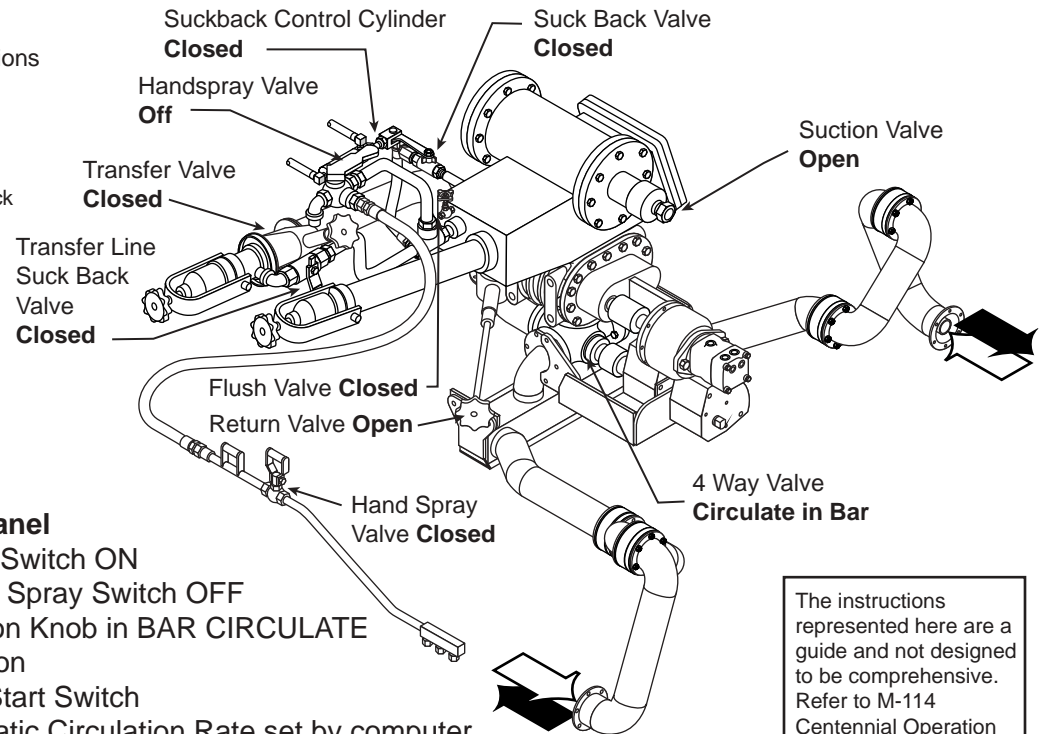
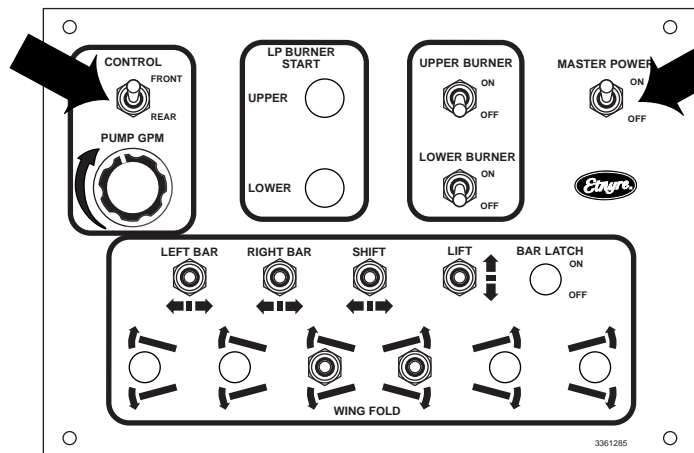

## Cab Panel

Power Switch ON  
Master Spray Switch OFF  
Function Knob in BAR CIRCULATE position  
Push Start Switch  
Automatic Circulation Rate set by computer depending on number of 1 ft switches turned on, the width of bar extended and the application rate desired.

The instructions represented here are a guide and not designed to be comprehensive. Refer to M-114 Centennial Operation Manual for complete instructions.

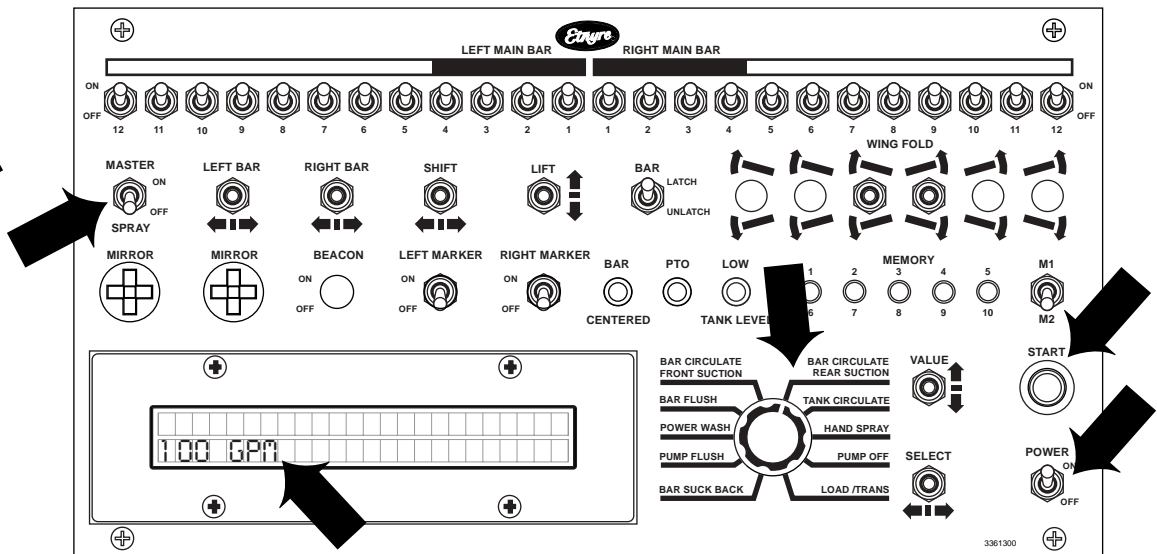

# Spray

## Hand Spray Valve Positions

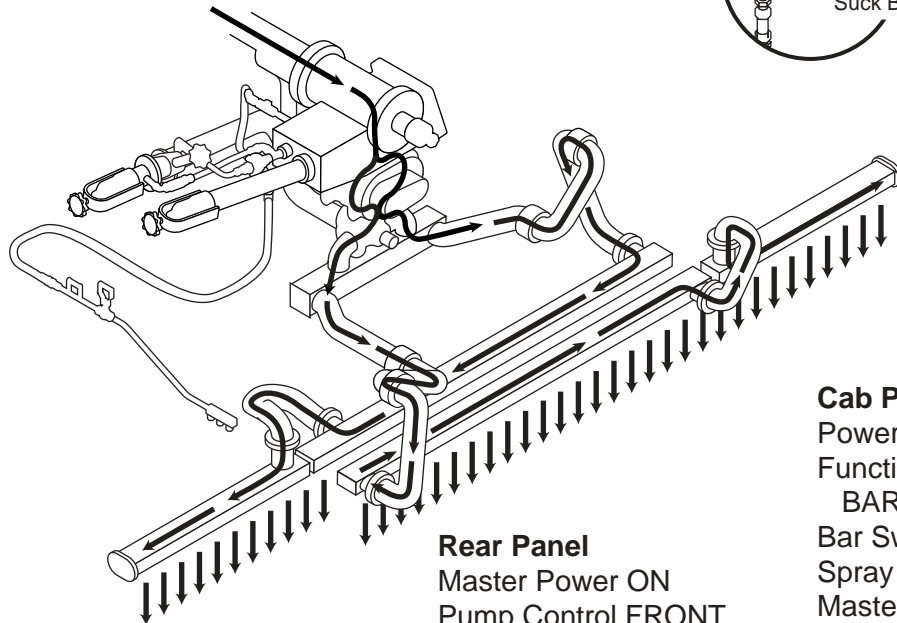
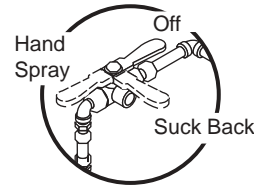

## Rear Panel

Master Power ON  
Pump Control FRONT  
Bar Latch OFF

To increase pump (GPM) using rear knob, place CONTROL switch to REAR and rotate knob.

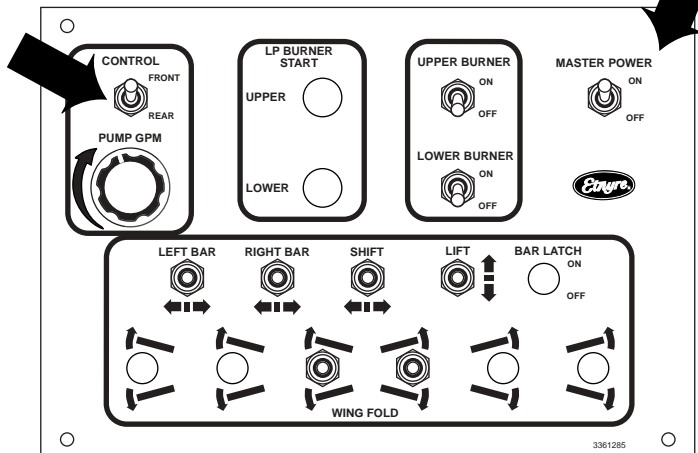

## Suckback Control Cylinder Closed

Handspray Valve Off  
Transfer Valve Closed

Transfer Line Suck Back Valve Closed

## Suck Back Valve Closed

Suction Valve Open

4 Way Valve Spray

Flush Valve Closed

Return Valve Open

Hand Spray Valve Closed

## Cab Panel

Power Switch ON  
Function Knob in BAR CIRCULATE position  
Bar Switch UNLATCH  
Spray Switches - activate to desired spray width  
Master Spray ON

The instructions represented here are a guide and not designed to be comprehensive. Refer to M-114 Centennial Operation Manual for complete instructions.

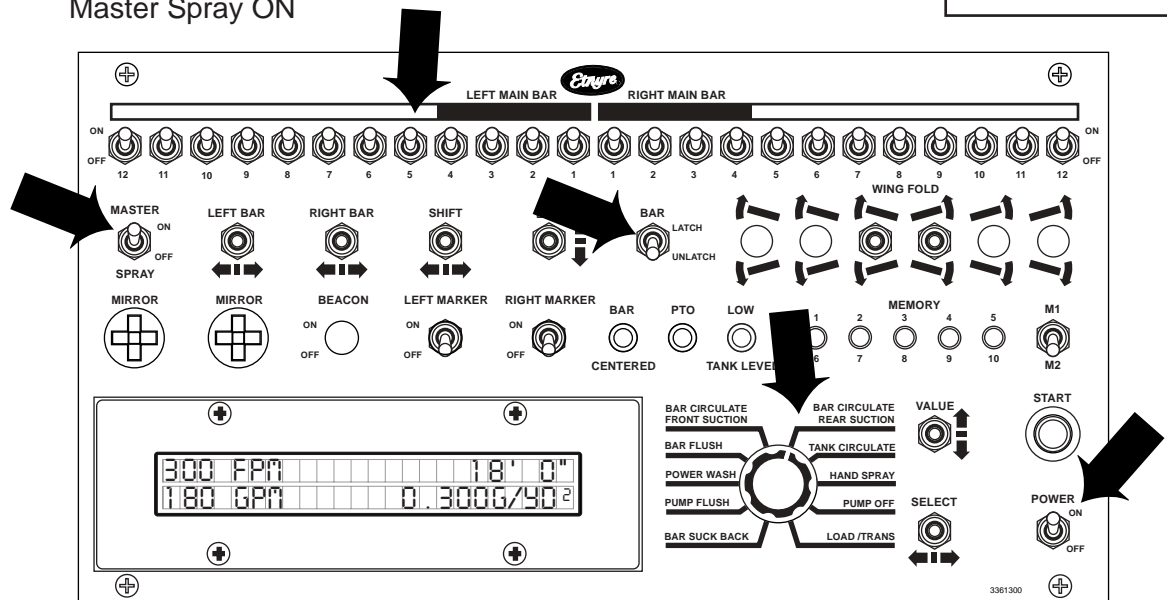



# Suckback Spraybar

Open bleeder valve at the end of one of the wings. Leave it open until you hear a positive indication of vacuum at the valve. After closing the valve, repeat the procedure on the opposite wing.

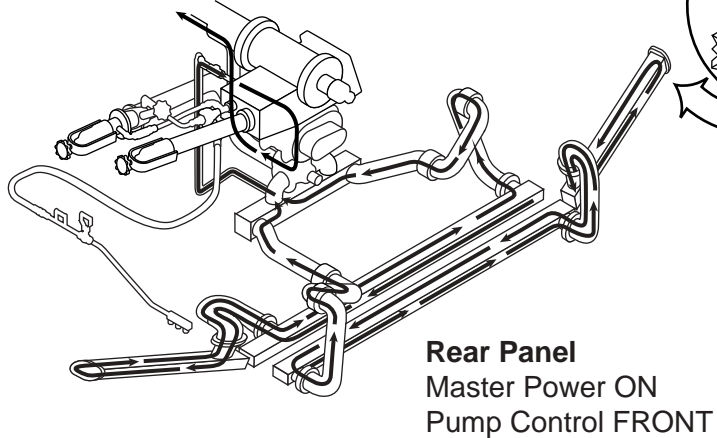

To increase pump (GPM) using rear knob, place CONTROL switch to REAR and rotate knob.

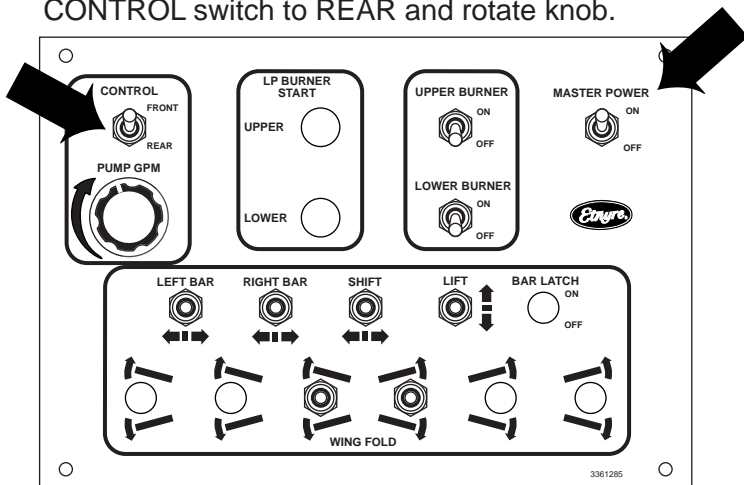

Hand Spray Valve Positions

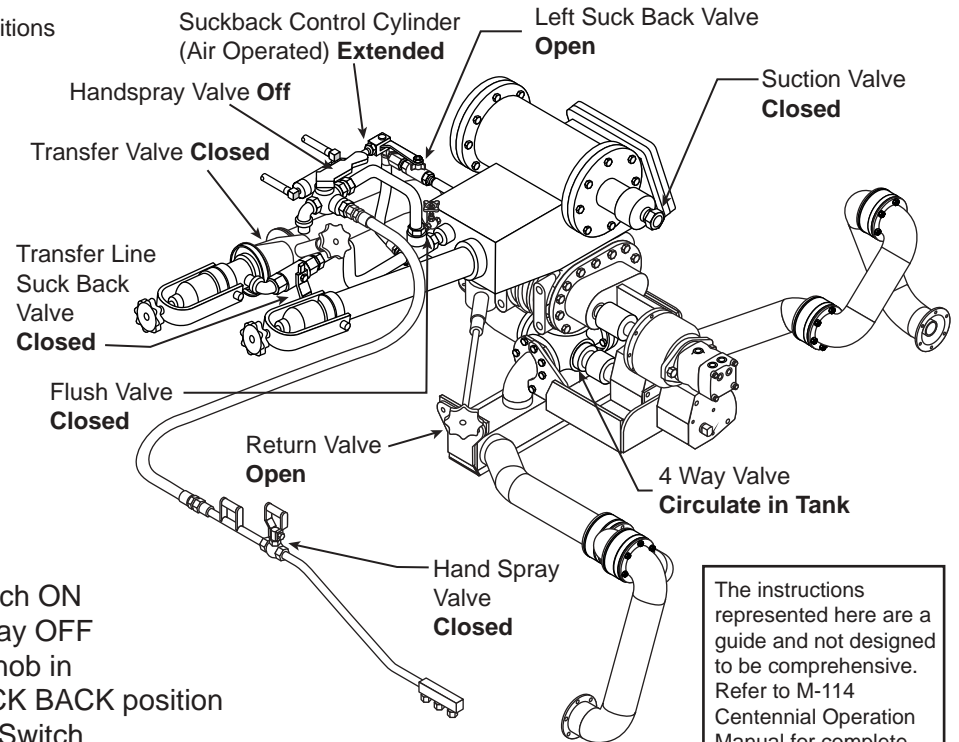
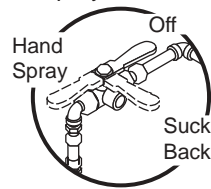

## Cab Panel

Power Switch ON  
Master Spray OFF  
Function Knob in  
BAR SUCK BACK position  
Push Start Switch  
200 GPM - 250 GPM

The instructions represented here are a guide and not designed to be comprehensive. Refer to M-114 Centennial Operation Manual for complete instructions.

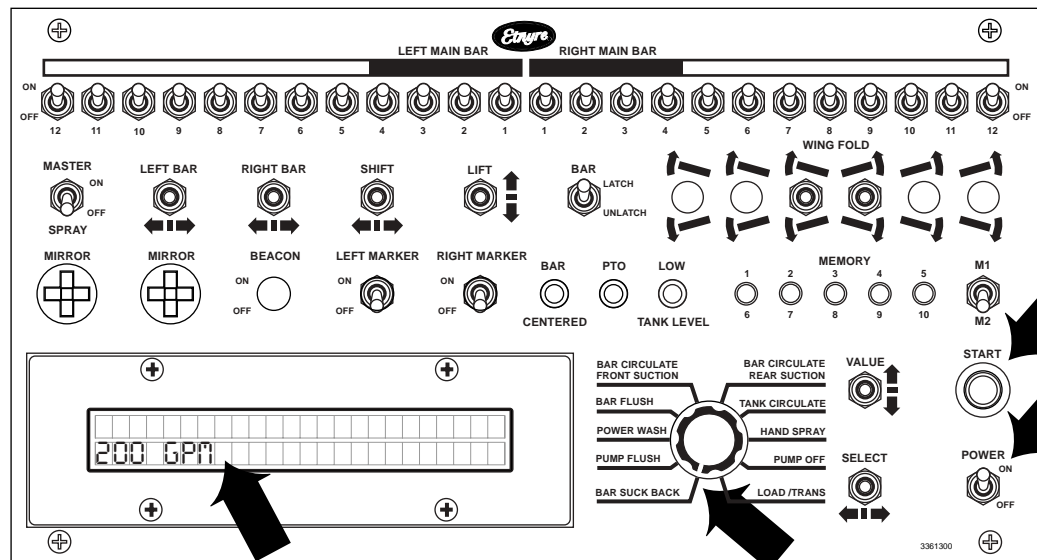

# Handspray

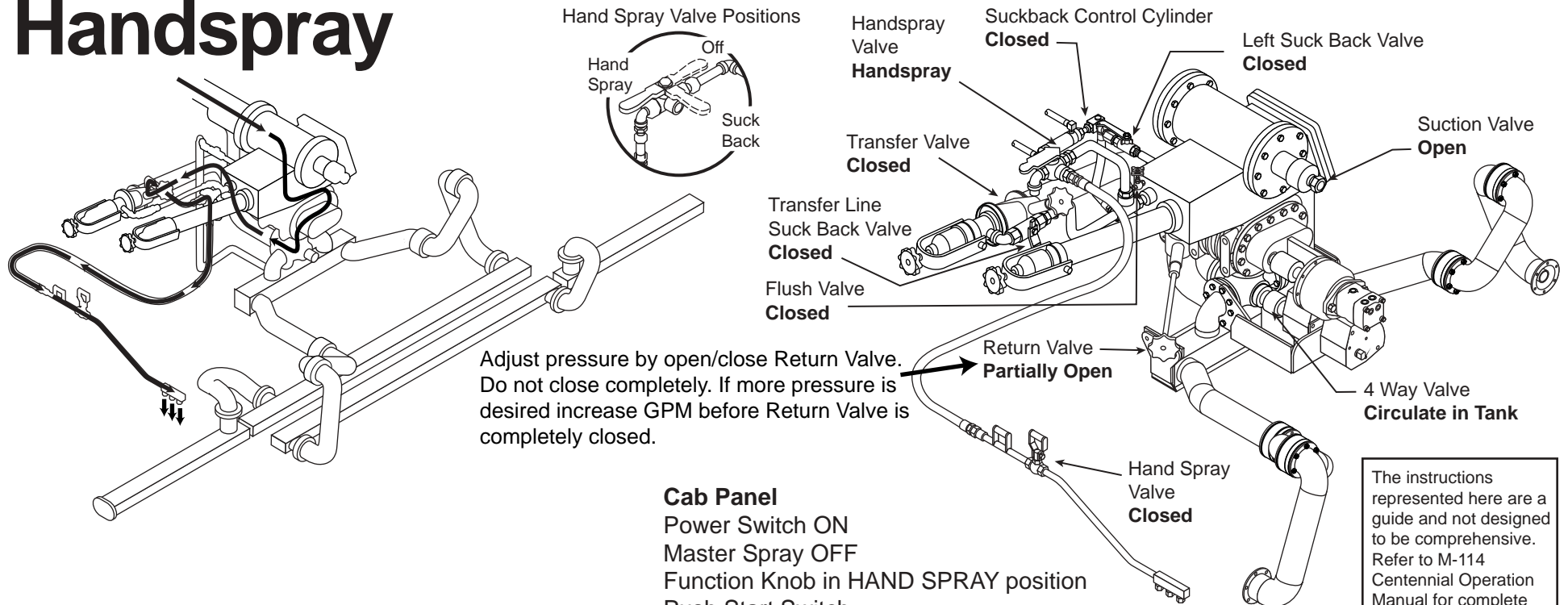

The instructions represented here are a guide and not designed to be comprehensive. Refer to M-114 Centennial Operation Manual for complete instructions.

## Cab Panel

Power Switch ON  
Master Spray OFF  
Function Knob in HAND SPRAY position  
Push Start Switch  
50 GPM

## Rear Panel

Master Power ON  
Pump Control FRONT

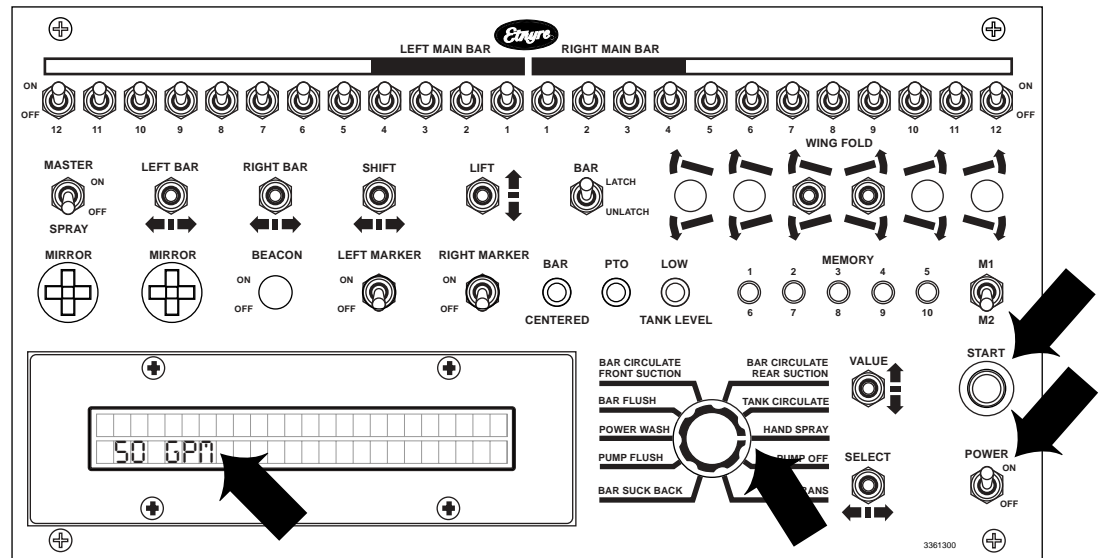
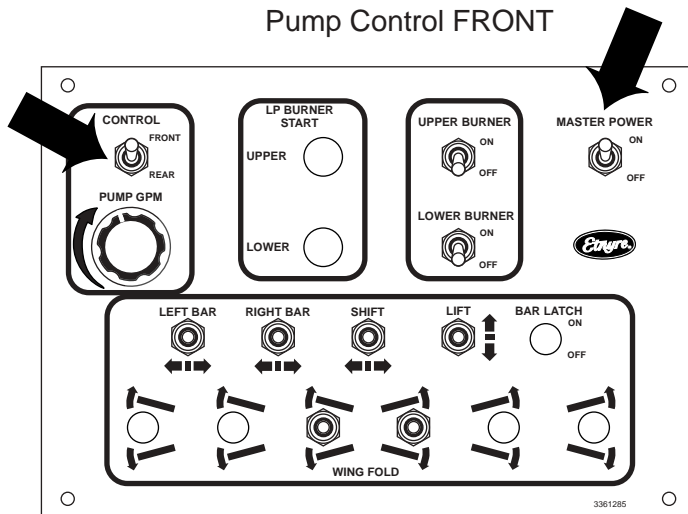

# Handspray Suckback

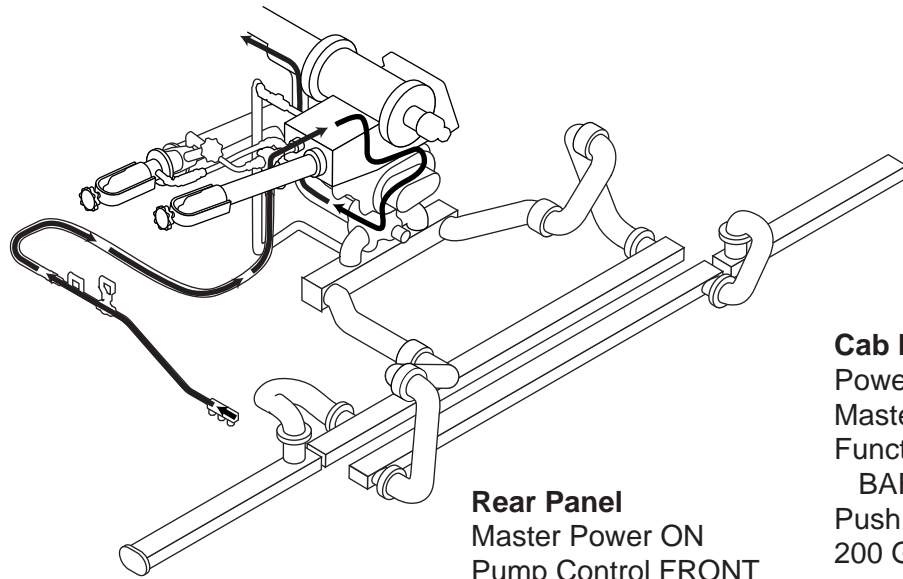

To increase pump (GPM) using rear knob, place CONTROL switch to REAR and rotate knob.

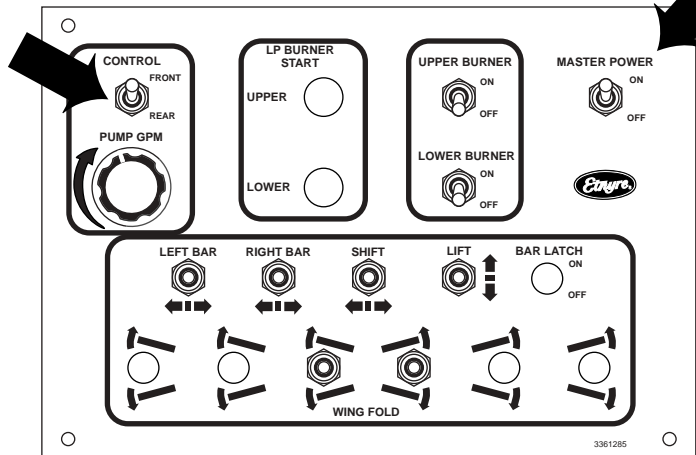

Hand Spray Valve Positions

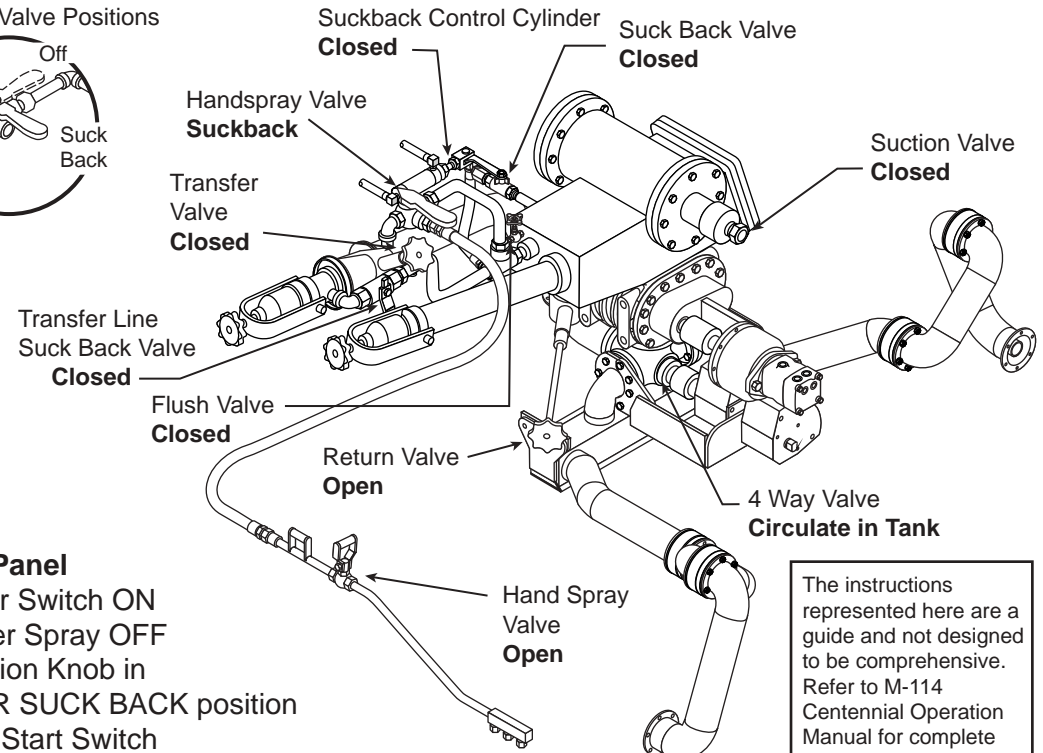
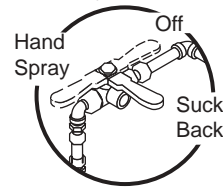

**Cab Panel**  
Power Switch ON  
Master Spray OFF  
Function Knob in  
BAR SUCK BACK position  
Push Start Switch  
200 GPM

The instructions represented here are a guide and not designed to be comprehensive. Refer to M-114 Centennial Operation Manual for complete instructions.

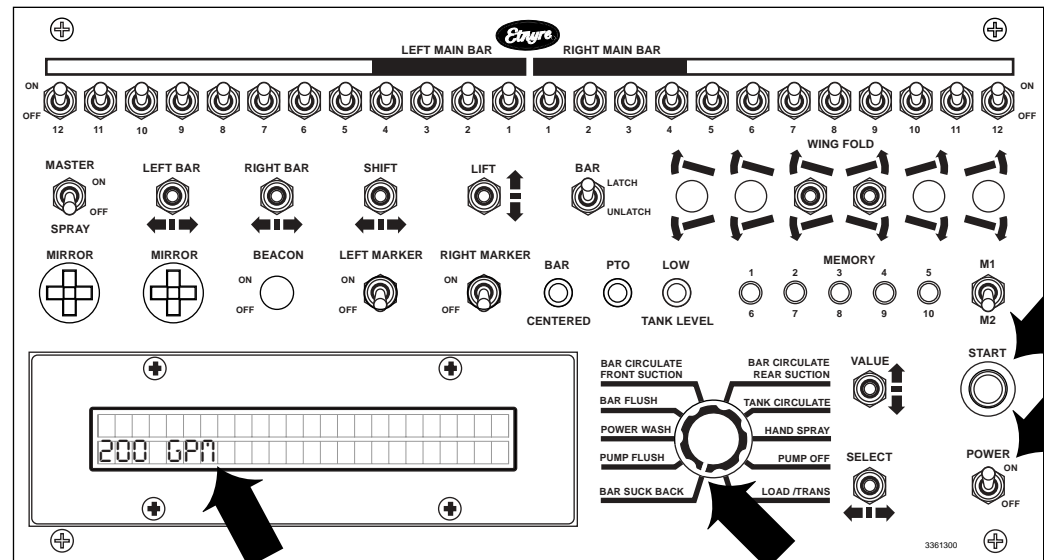

# Pump Off

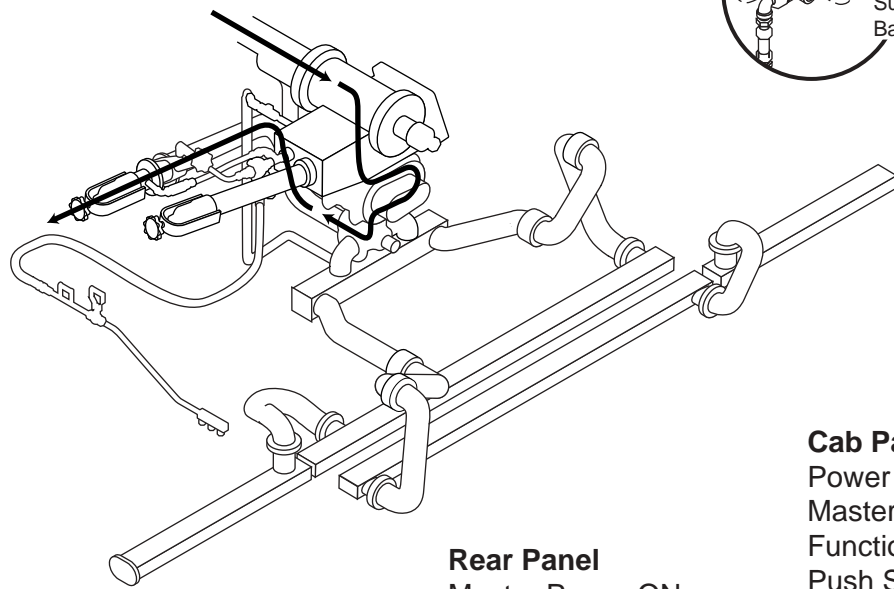

**Rear Panel**  
Master Power ON  
Pump Control FRONT

To increase pump (GPM) using rear knob, place CONTROL switch to REAR and rotate knob.

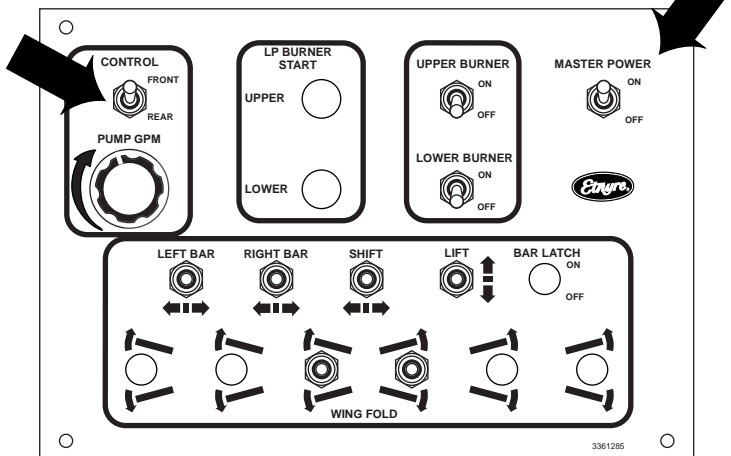

Hand Spray Valve Positions

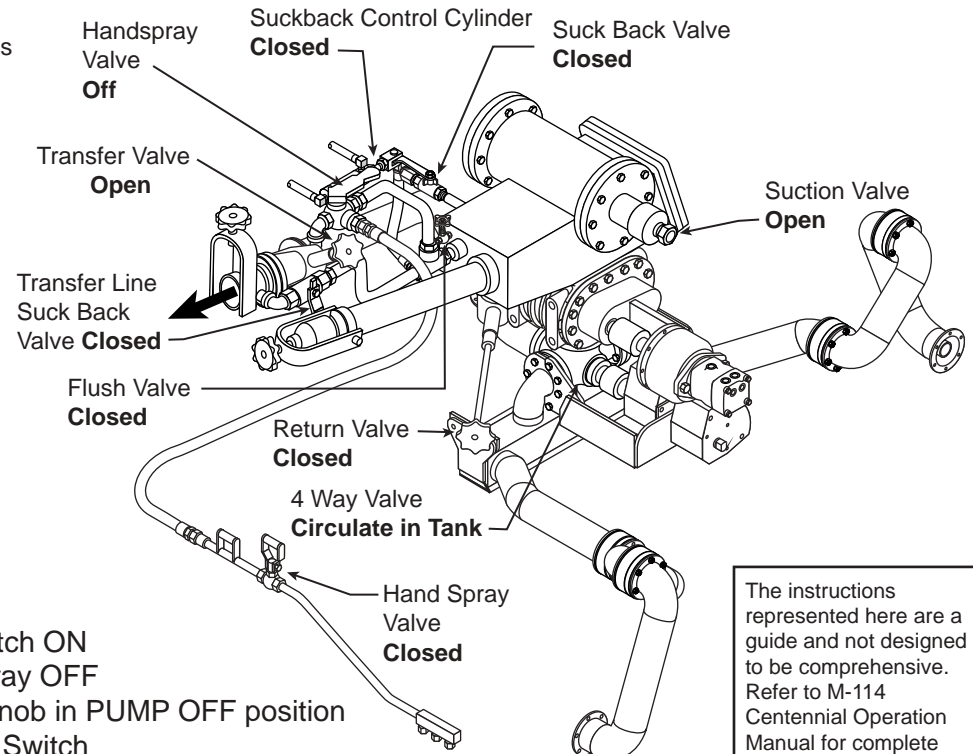
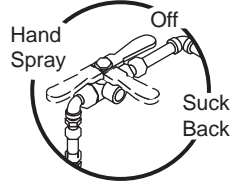

## Cab Panel

Power Switch ON  
Master Spray OFF  
Function Knob in PUMP OFF position  
Push Start Switch  
150 GPM

The instructions represented here are a guide and not designed to be comprehensive. Refer to M-114 Centennial Operation Manual for complete instructions.

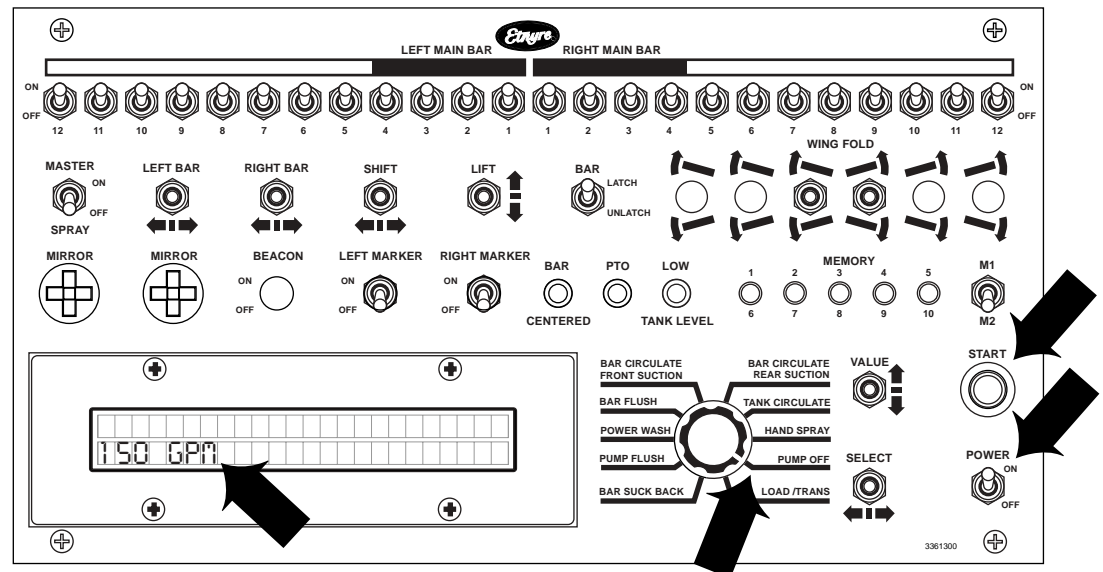



# Transfer

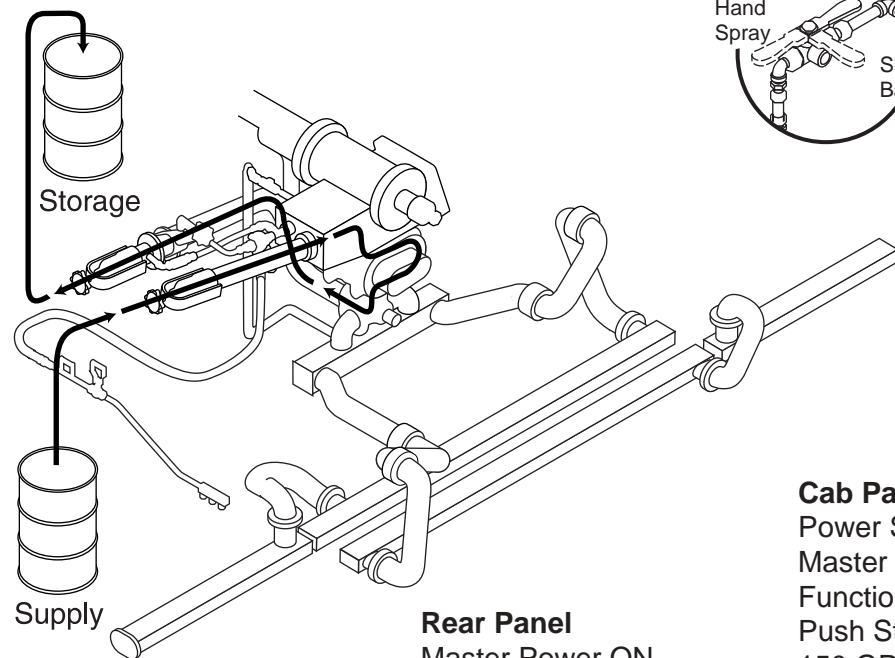

**Rear Panel**  
Master Power ON  
Pump Control FRONT

To increase pump (GPM) using rear knob, place CONTROL switch to REAR and rotate knob.

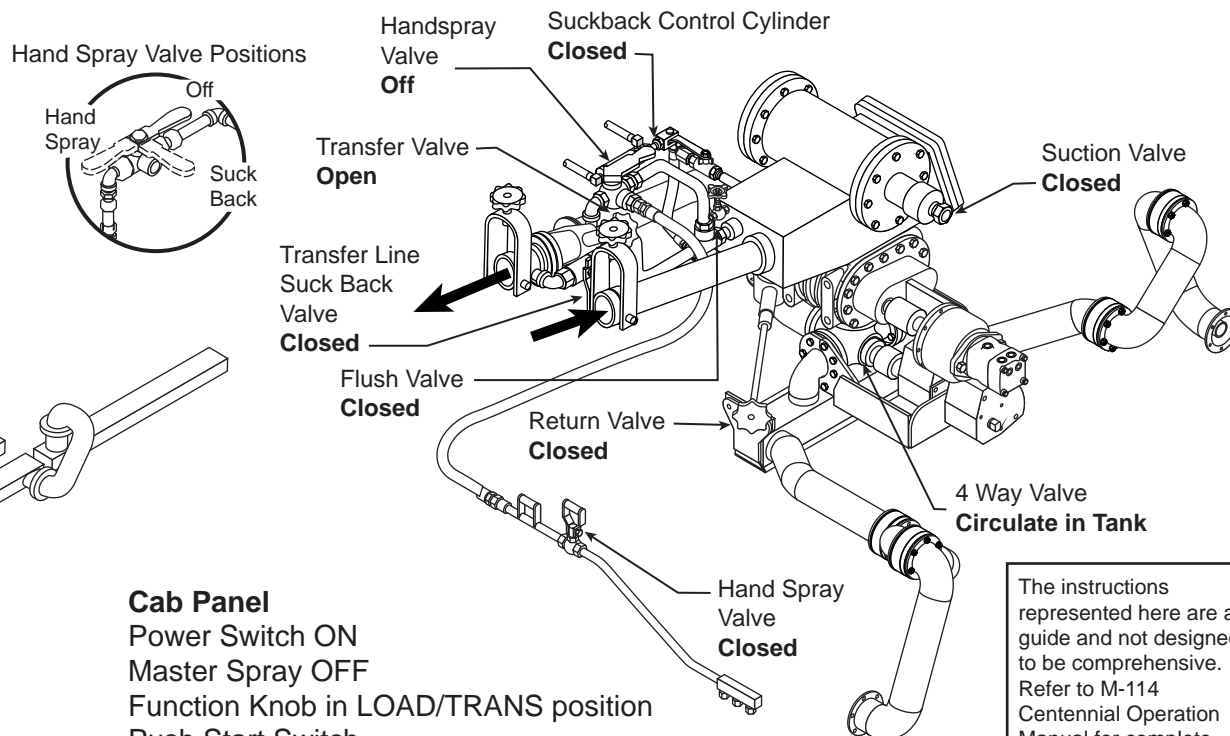
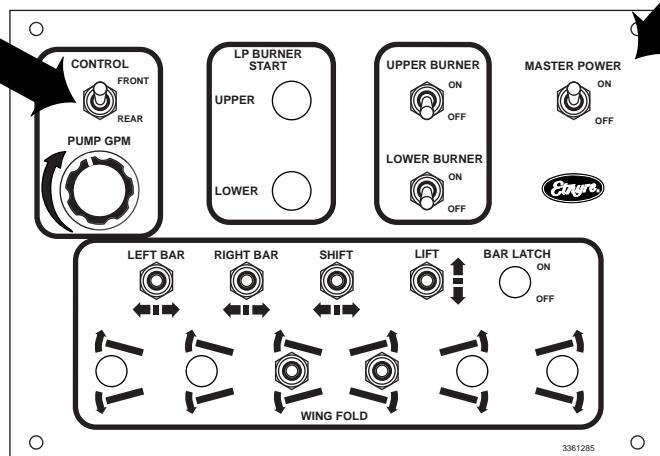

**Cab Panel**  
Power Switch ON  
Master Spray OFF  
Function Knob in LOAD/TRANS position  
Push Start Switch  
150 GPM

The instructions represented here are a guide and not designed to be comprehensive. Refer to M-114 Centennial Operation Manual for complete instructions.

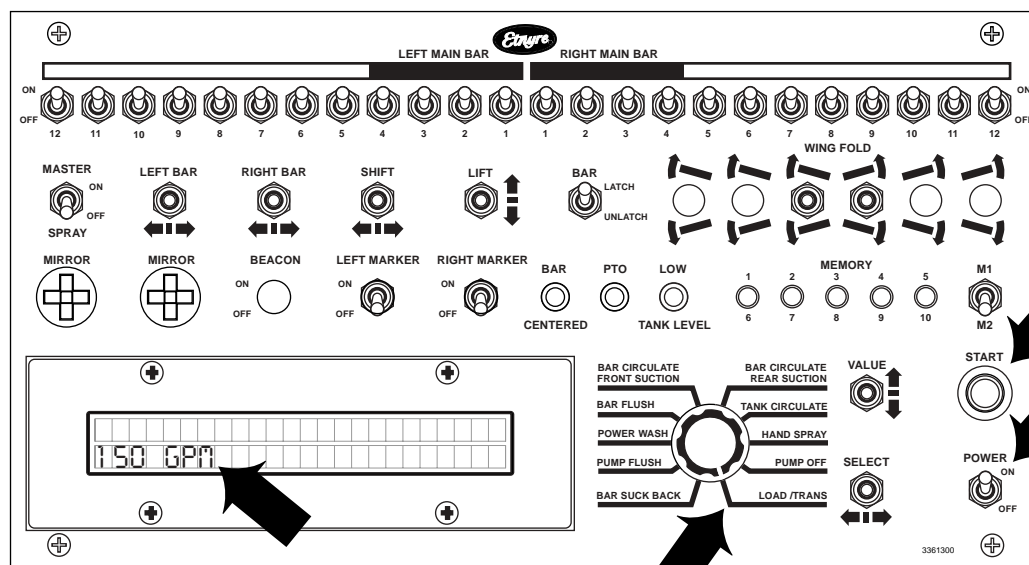

# Flushing

Hand Spray Valve Positions

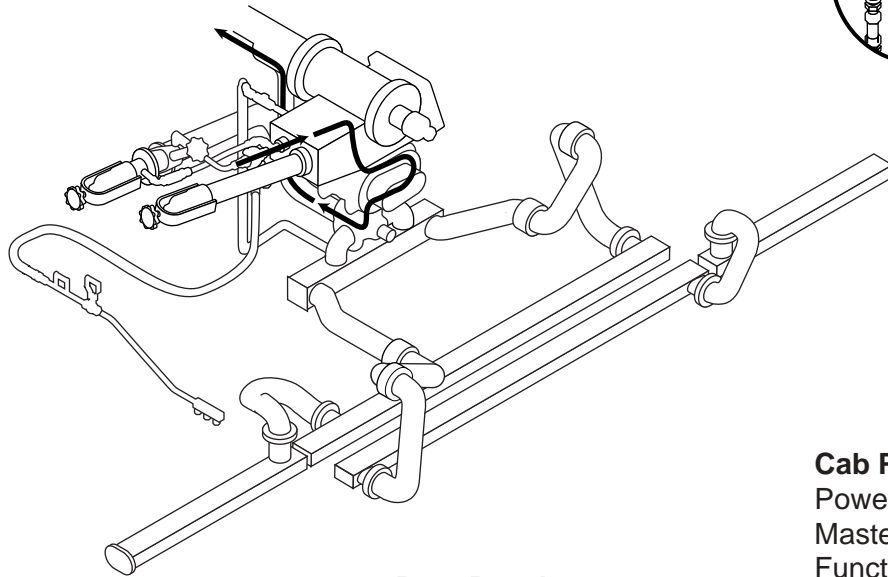
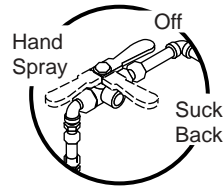

**Rear Panel**  
Master Power ON  
Pump Control FRONT

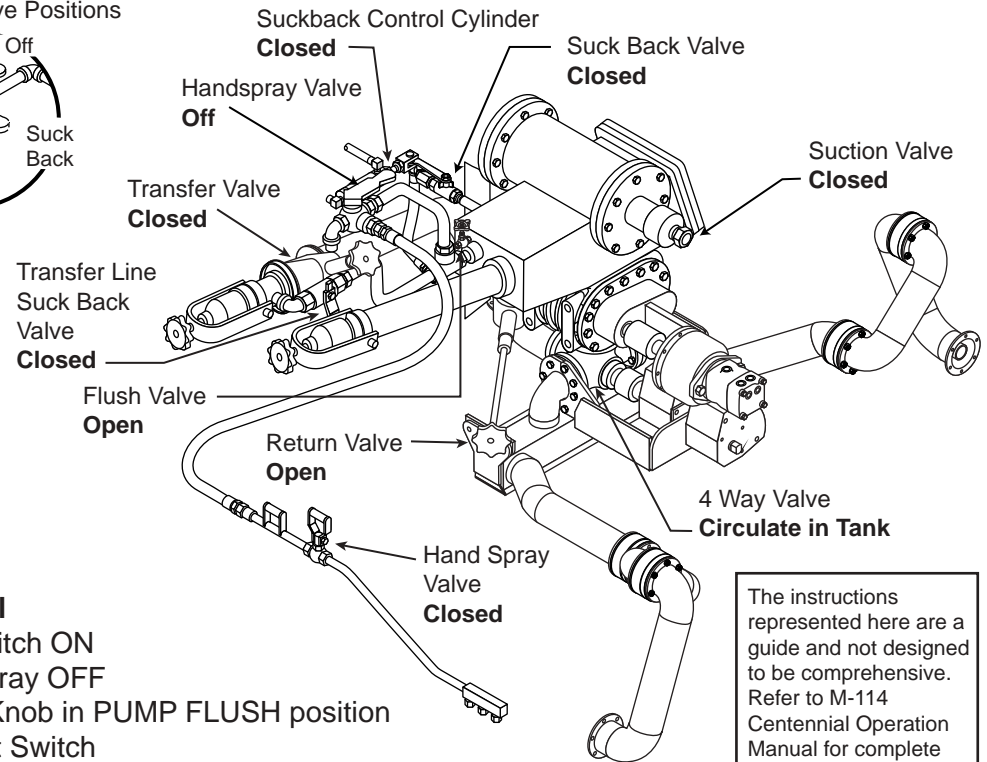

## Cab Panel

Power Switch ON  
Master Spray OFF  
Function Knob in PUMP FLUSH position  
Push Start Switch  
100 GPM

The instructions represented here are a guide and not designed to be comprehensive. Refer to M-114 Centennial Operation Manual for complete instructions.

To increase pump (GPM) using rear knob, place CONTROL switch to REAR and rotate knob.

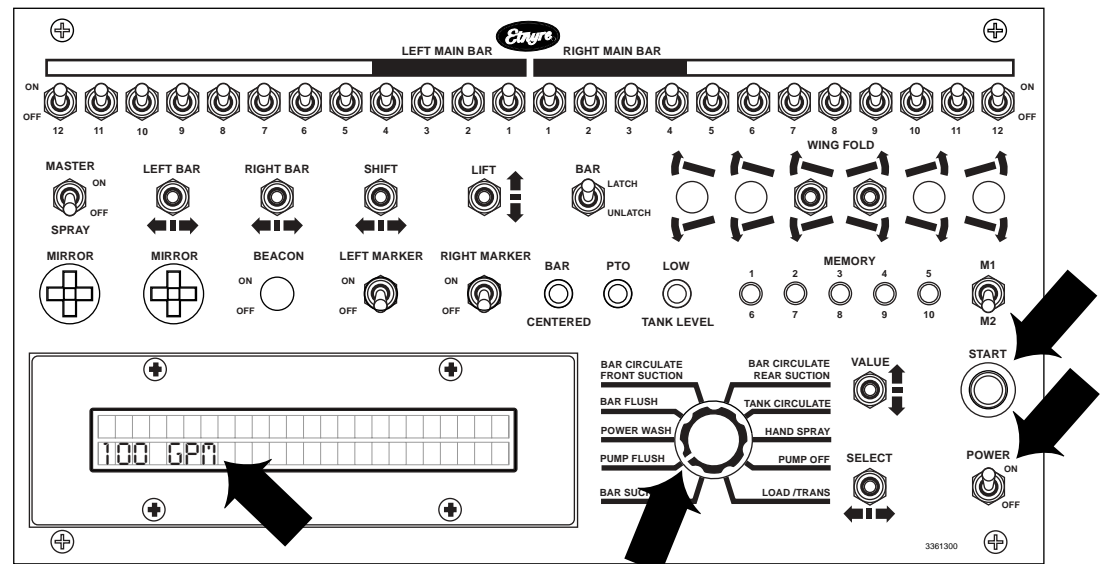
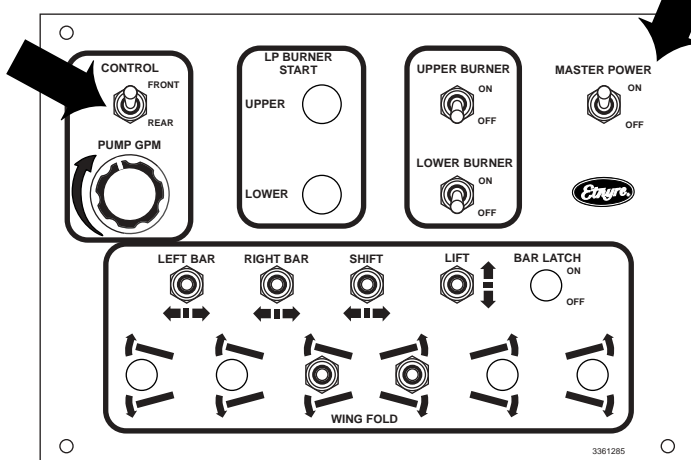

# Flushing Bar

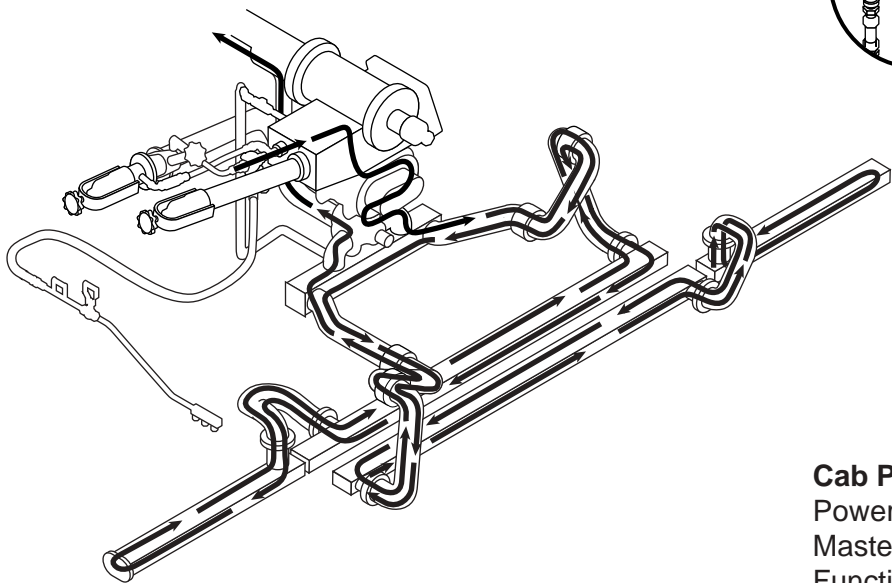

**Rear Panel**  
Master Power ON  
Pump Control FRONT

To increase pump (GPM) using rear knob, place CONTROL switch to REAR and rotate knob.

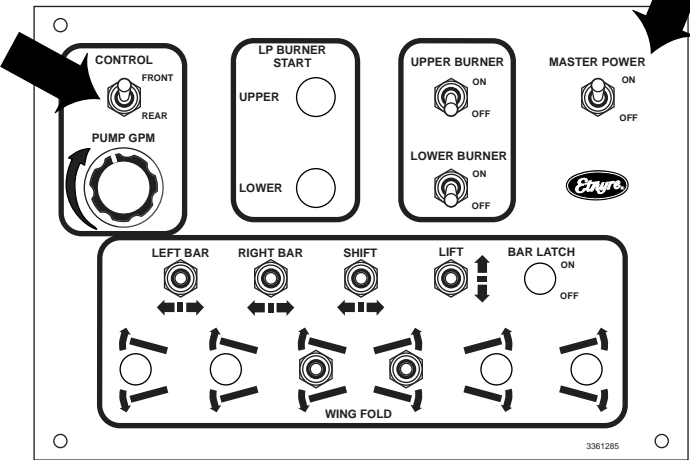

Hand Spray Valve Positions

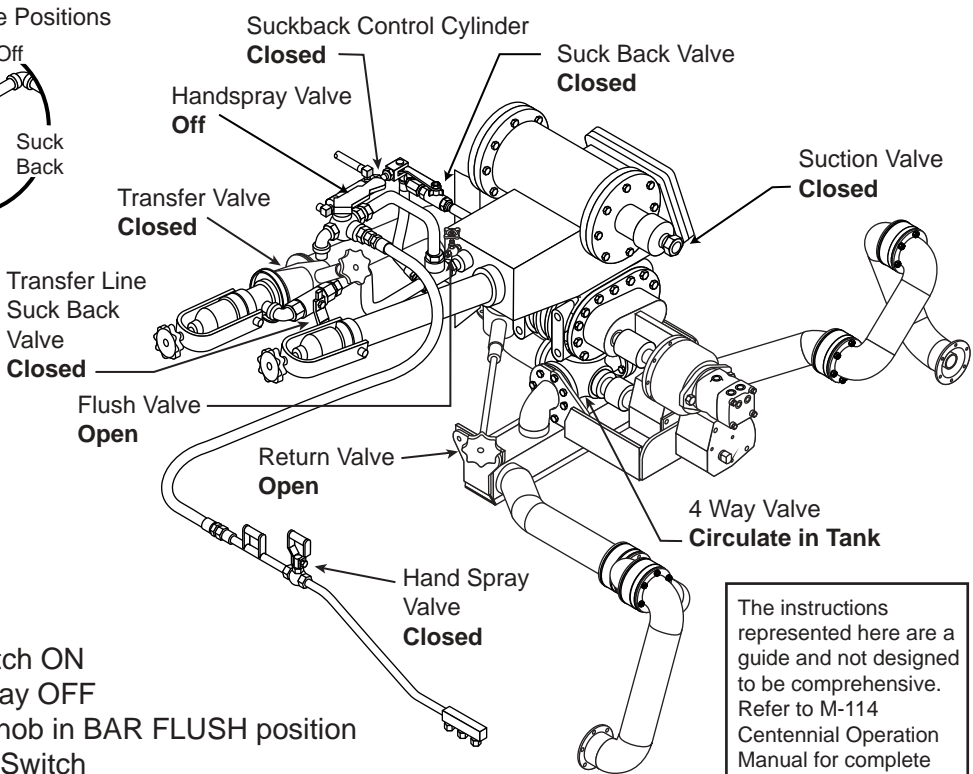
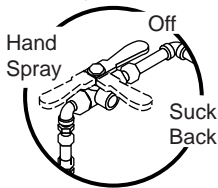

**Cab Panel**  
Power Switch ON  
Master Spray OFF  
Function Knob in BAR FLUSH position  
Push Start Switch  
100 GPM

The instructions represented here are a guide and not designed to be comprehensive. Refer to M-114 Centennial Operation Manual for complete instructions.

