

FEATURE	DESCRIPTION	SPECIFICATION
Capacity	Tilt Out Bag Cage	9-1/2 cu.ft. 70 US Gallons (265L)
	Poly Bag	2.5 mil 42 x 50 (1070 x 1270)
Construction	Housing	12 Ga. (2.6) Galvanneal Steel
	Lid	14 Ga. (1.9) Galvanneal Steel
	User Door	14 Ga. (1.9) Galvanneal Steel
	Side Hinged Unloading Door	14 Ga. (1.9) Galvanneal Steel
	Hinges and Latches	Stainless Steel
	Paint	Powder Coat
Weights	Standard Hid-A-Bag I	220lbs (100kg)
	(Optional) Pre-Cast Mounting Pad (HBI-572)	345lbs (155kg) 28 x 36 x 4 (710 x 915 x 102)

ALL SPECIFICATIONS SUBJECT TO CHANGE WITHOUT NOTICE

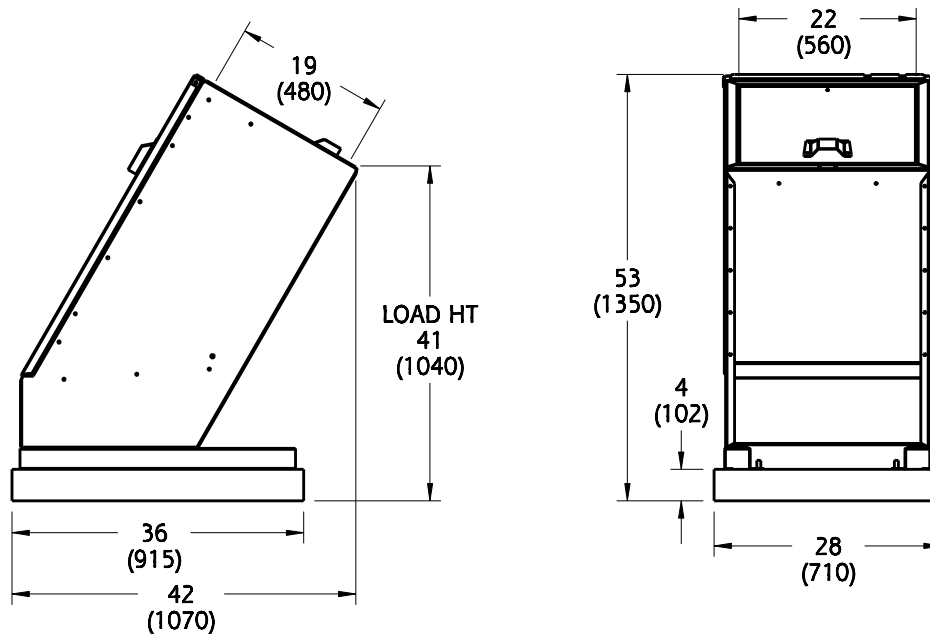
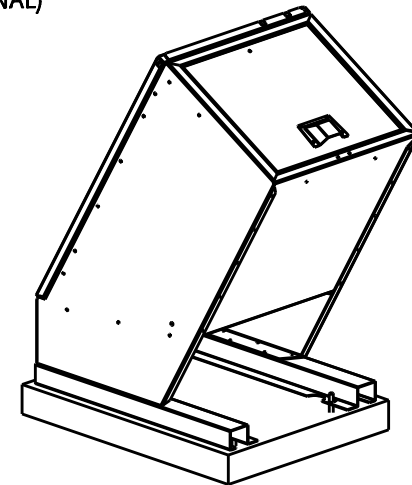
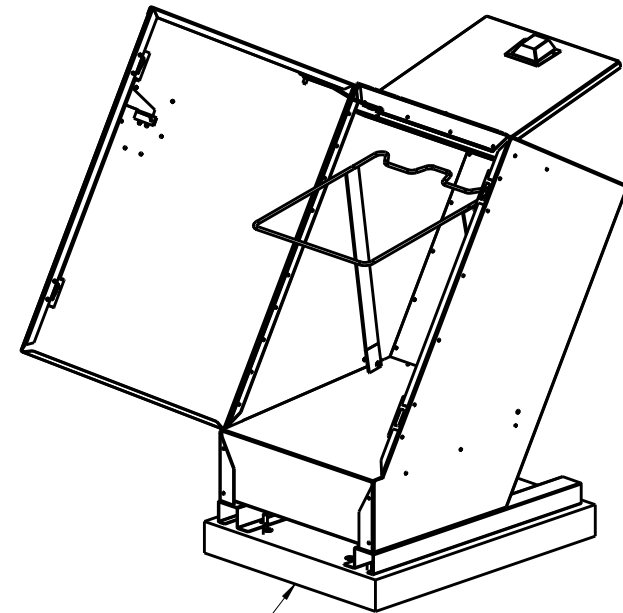

NOTE: ALL DIMENSIONS INCHES (MILLIMETERS)

TRAILER SIZE	QTY	HAUL-ALL EQUIPMENT LTD. reserves proprietary rights on this drawing or any part of the information contained thereon. This drawing shall be considered confidential material and is not to be used for competitive bidding nor for use in any procurements other than from Haul-All Equipment Ltd.	NAME HBIS CONTAINER (STANDARD)				
8-1/2ft x 45ft	45			PART NUMBER	SP-HBIS-N	DRAWN BY	PS
8-1/2ft x 53ft	54			DATE	AUGUST 19, 2016	REVISION	1
B-Train 8-1/2ft x 28ft & 32ft	54						
Double Decker Van 8-1/2ft x 48ft	96						

FEATURE	DESCRIPTION	SPECIFICATION
Capacity	Tilt Out Bag Cage	9-1/2 cu.ft. 70 US Gallons (265L)
	Poly Bag	2.5 mil 42 x 50 (1070 x 1270)
Construction	Housing	12 Ga. (2.6) Galvanneal Steel
	Lid	14 Ga. (1.9) Galvanneal Steel
	User Door	14 Ga. (1.9) Galvanneal Steel
	Side Hinged Unloading Door	14 Ga. (1.9) Galvanneal Steel
	Hinges and Latches	Stainless Steel
	Paint	Powder Coat
Weights	Standard Hid-A-Bag I	220lbs (100kg)
	(Optional) Pre-Cast Mounting Pad (HBI-572)	345lbs (155kg) 28 x 36 x 4 (710 x 915 x 102)

ALL SPECIFICATIONS SUBJECT TO CHANGE WITHOUT NOTICE

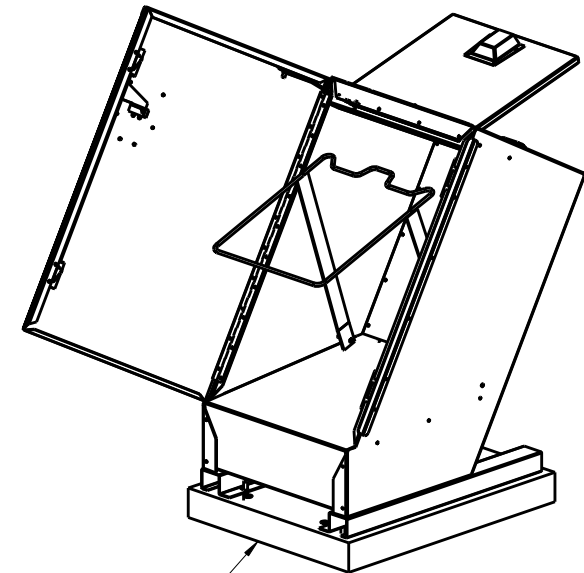

MOUNTING PAD (OPTIONAL)

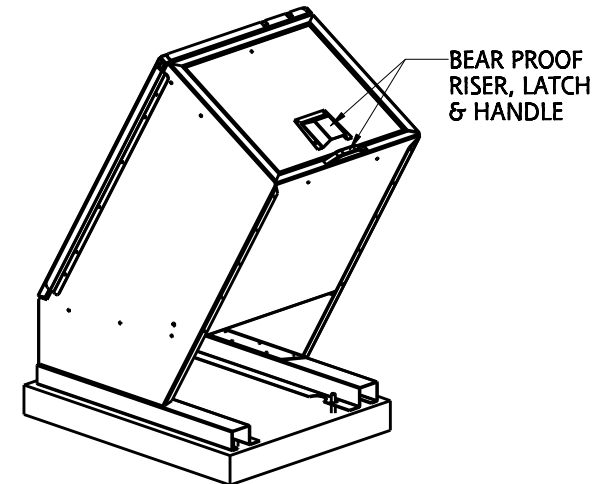

BEAR PROOF RISER, LATCH & HANDLE

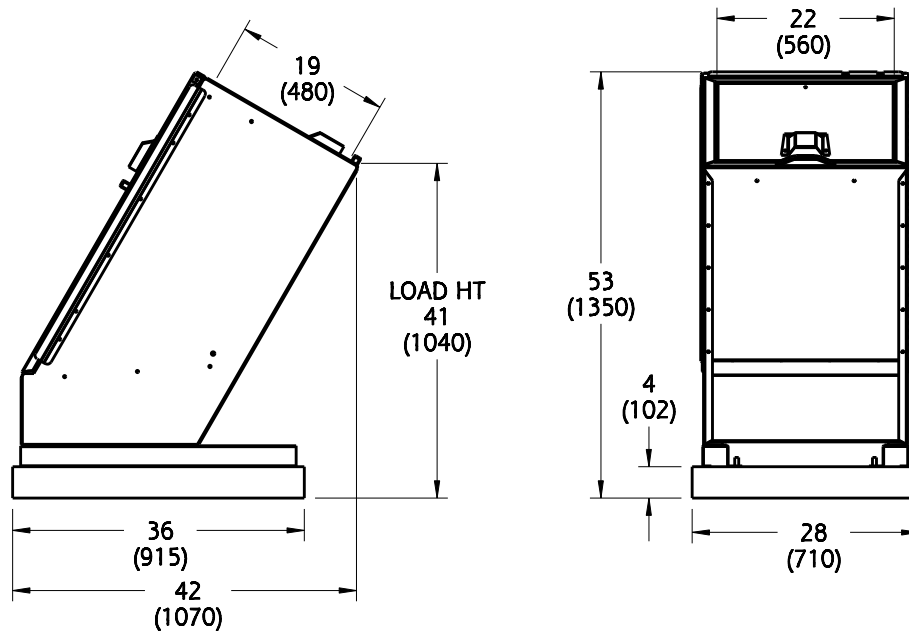

NOTE: ALL DIMENSIONS INCHES (MILLIMETERS)

TRAILER SIZE	QTY	HAUL-ALL EQUIPMENT LTD. reserves proprietary rights on this drawing or any part of the information contained thereon. This drawing shall be considered confidential material and is not to be used for competitive bidding nor for use in any procurements other than from Haul-All Equipment Ltd.	NAME		
8-1/2ft x 45ft	45			HBIS BP CONTAINER	
8-1/2ft x 53ft	54			PART NUMBER	SP-HBIS-P
B-Train 8-1/2ft x 28ft & 32ft	54		DATE	AUGUST 19, 2016	REVISION 1
Double Decker Van 8-1/2ft x 48ft	96				

FEATURE	DESCRIPTION	SPECIFICATION
Capacity	Tilt Out Bag Cage	9-1/2 cu.ft. 70 US Gallons (265L)
	Poly Bag	2.5 mil 42 x 50 (1070 x 1270)
Construction	Housing	12 Ga. (2.6) Galvanneal Steel
	Lid	14 Ga. (1.9) Galvanneal Steel
	User Door	14 Ga. (1.9) Galvanneal Steel
	Side Hinged Unloading Door	14 Ga. (1.9) Galvanneal Steel
	Hinges and Latches	Stainless Steel
	Paint	Powder Coat
Weights	Standard Hid-A-Bag I	220lbs (100kg)
	(Optional) Pre-Cast Mounting Pad (HBI-572)	345lbs (155kg) 28 x 36 x 4 (710 x 915 x 102)

ALL SPECIFICATIONS SUBJECT TO CHANGE WITHOUT NOTICE

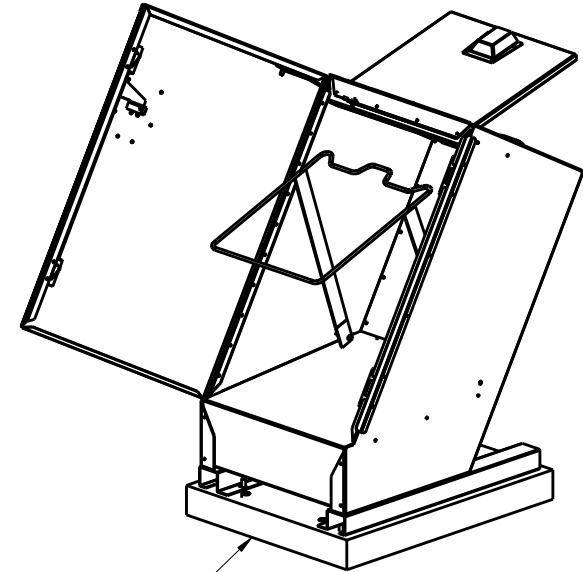

MOUNTING PAD (OPTIONAL)

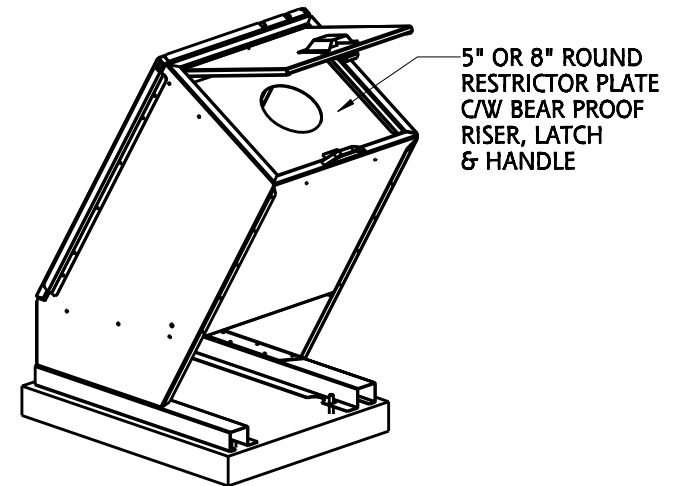

5" OR 8" ROUND RESTRICTOR PLATE C/W BEAR PROOF RISER, LATCH & HANDLE

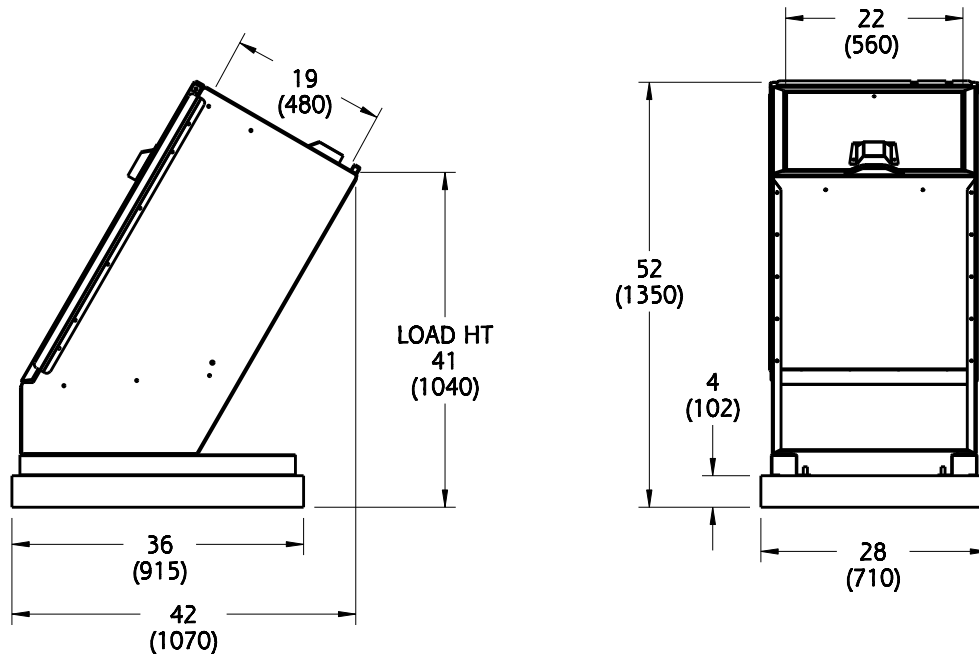

NOTE: ALL DIMENSIONS INCHES (MILLIMETERS)

TRAILER SIZE	QTY	HAUL-ALL EQUIPMENT LTD. reserves proprietary rights on this drawing or any part of the information contained thereon. This drawing shall be considered confidential material and is not to be used for competitive bidding nor for use in any procurements other than from Haul-All Equipment Ltd.	NAME HBIS BP CONTAINER (RESTRICTOR)			
8-1/2ft x 45ft	45			PART NUMBER	SP-HBIS-PR	DRAWN BY PS
8-1/2ft x 53ft	54			DATE	AUGUST 19, 2016	REVISION 1
B-Train 8-1/2ft x 28ft & 32ft	54					
Double Decker Van 8-1/2ft x 48ft	96					

FEATURE	DESCRIPTION	SPECIFICATION
Capacity	Tilt Out Bag Cage	9-1/2 cu.ft. 70 US Gallons (265L)
	Poly Bag	2.5 mil 42 x 50 (1070 x 1270)
Construction	Housing	12 Ga. (2.6) Galvanneal Steel
	Lid	14 Ga. (1.9) Galvanneal Steel
	User Door	14 Ga. (1.9) Galvanneal Steel
	Side Hinged Unloading Door	14 Ga. (1.9) Galvanneal Steel
	Hinges and Latches	Stainless Steel
	Paint	Powder Coat
Weights	Standard Hid-A-Bag I	220lbs (100kg)
	(Optional) Pre-Cast Mounting Pad (HBI-572)	345lbs (155kg) 28 x 36 x 4 (710 x 915 x 102)

ALL SPECIFICATIONS SUBJECT TO CHANGE WITHOUT NOTICE

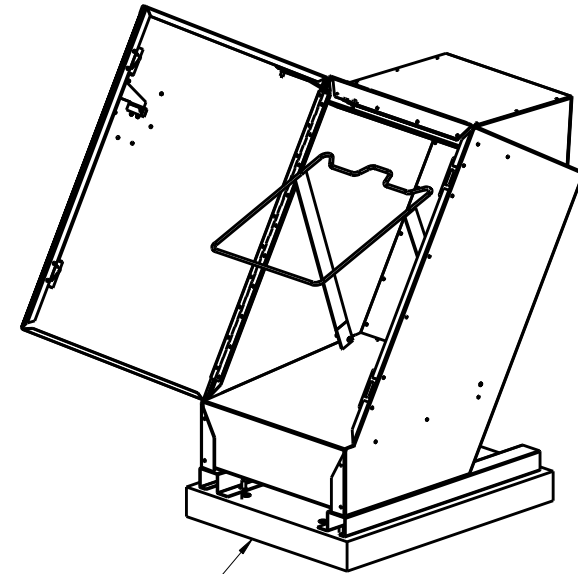

MOUNTING PAD
(OPTIONAL)

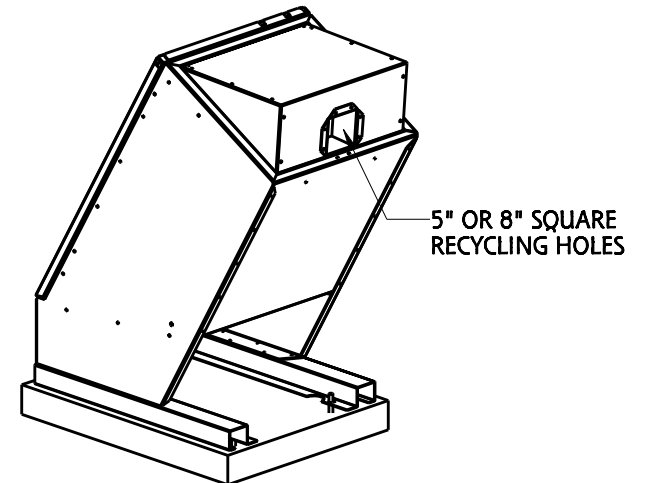

5" OR 8" SQUARE
RECYCLING HOLES

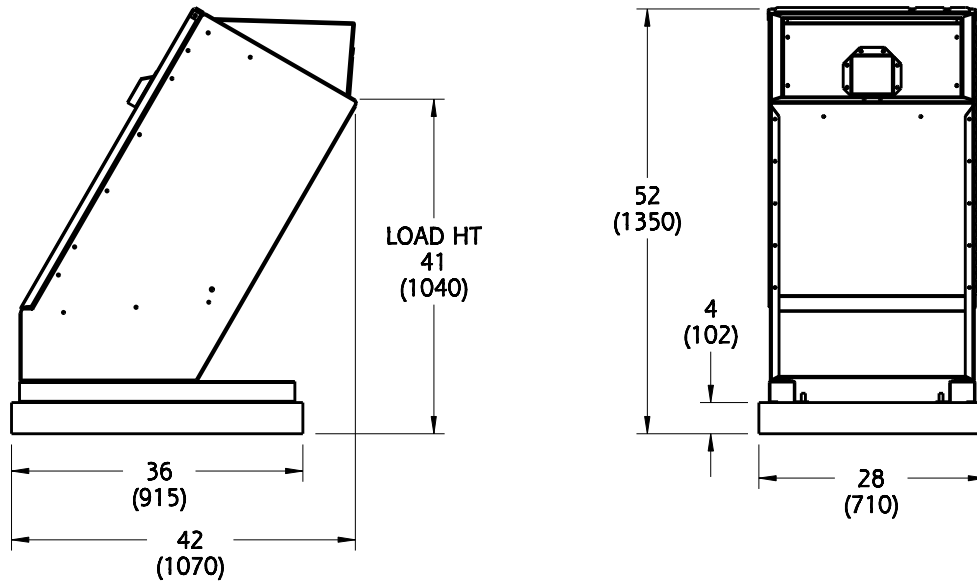

NOTE: ALL DIMENSIONS INCHES (MILLIMETERS)

TRAILER SIZE	QTY	HAUL-ALL EQUIPMENT LTD. reserves proprietary rights on this drawing or any part of the information contained thereon. This drawing shall be considered confidential material and is not to be used for competitive bidding nor for use in any procurements other than from Haul-All Equipment Ltd.	NAME HBIS CONTAINER (SQUARE RECYCLE)		
8-1/2ft x 45ft	45		PART NUMBER	SP-HBIS-Y	DRAWN BY PS
8-1/2ft x 53ft	54		DATE	AUGUST 19, 2016	REVISION 1
B-Train 8-1/2ft x 28ft & 32ft	54				
Double Decker Van 8-1/2ft x 48ft	96				



FEATURE	DESCRIPTION	SPECIFICATION
Capacity	Tilt Out Bag Cage	9-1/2 cu.ft. 70 US Gallons (265L)
	Poly Bag	2.5 mil 42 x 50 (1070 x 1270)
Construction	Housing	12 Ga. (2.6) Galvanneal Steel
	Lid	14 Ga. (1.9) Galvanneal Steel
	User Door	14 Ga. (1.9) Galvanneal Steel
	Side Hinged Unloading Door	14 Ga. (1.9) Galvanneal Steel
	Hinges and Latches	Stainless Steel
	Paint	Powder Coat
Weights	Standard Hid-A-Bag I	220lbs (100kg)
	(Optional) Pre-Cast Mounting Pad (HBI-572)	345lbs (155kg) 28 x 36 x 4 (710 x 915 x 102)

ALL SPECIFICATIONS SUBJECT TO CHANGE WITHOUT NOTICE

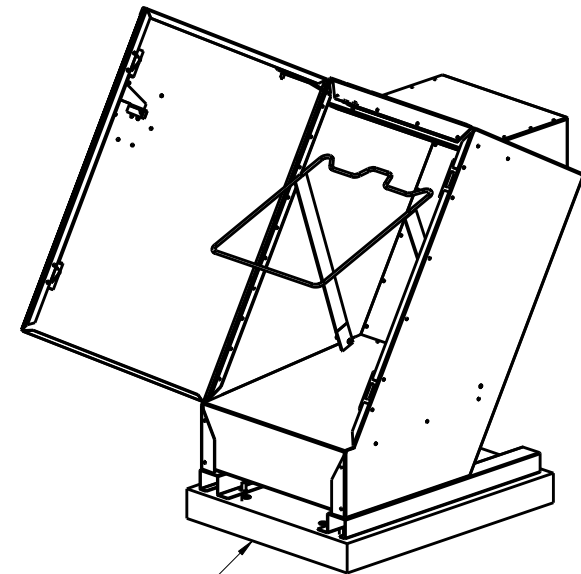

MOUNTING PAD (OPTIONAL)

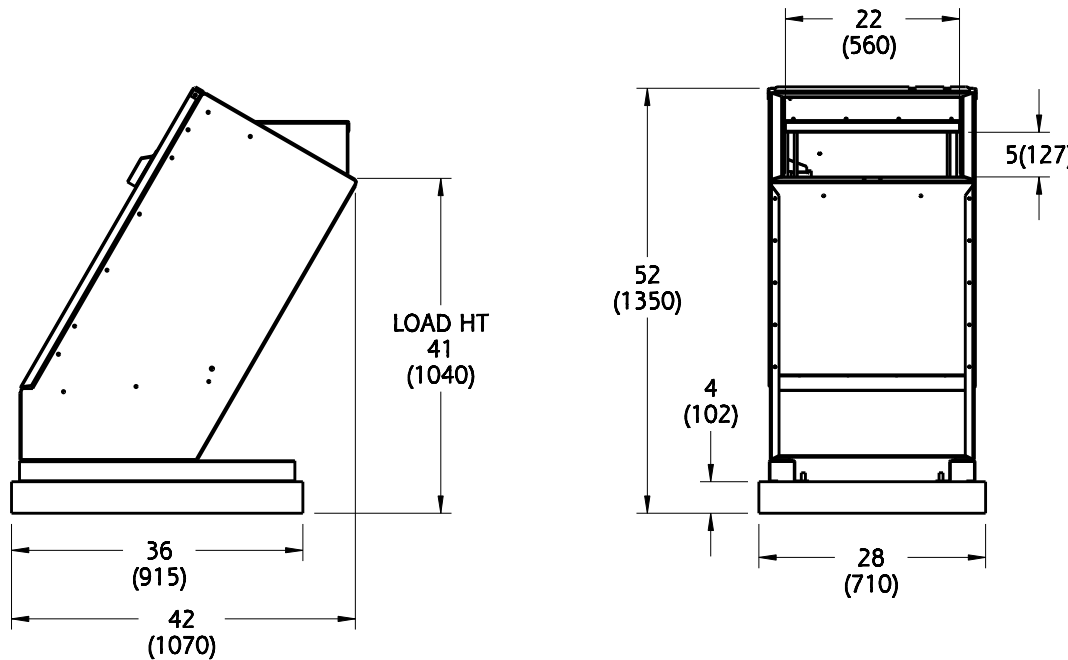
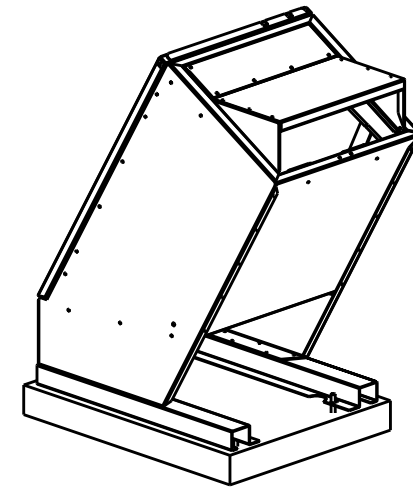

NOTE: ALL DIMENSIONS INCHES (MILLIMETERS)

TRAILER SIZE	QTY	HAUL-ALL EQUIPMENT LTD. reserves proprietary rights on this drawing or any part of the information contained thereon. This drawing shall be considered confidential material and is not to be used for competitive bidding nor for use in any procurements other than from Haul-All Equipment Ltd.	NAME HBIS CONTAINER (PAPER CHUTE)				
8-1/2ft x 45ft	45			PART NUMBER	SP-HBIS-U	DRAWN BY	PS
8-1/2ft x 53ft	54			DATE	AUGUST 19, 2016	REVISION	1
B-Train 8-1/2ft x 28ft & 32ft	54						
Double Decker Van 8-1/2ft x 48ft	96						